

INSTAFLEX –  
the complete piping system  
d 16 – d 110 for potable  
water installations

As well as for  
industrial applications

INSTAFLEX

Fitting for Socket Fusion Jointing

Product Range 2005

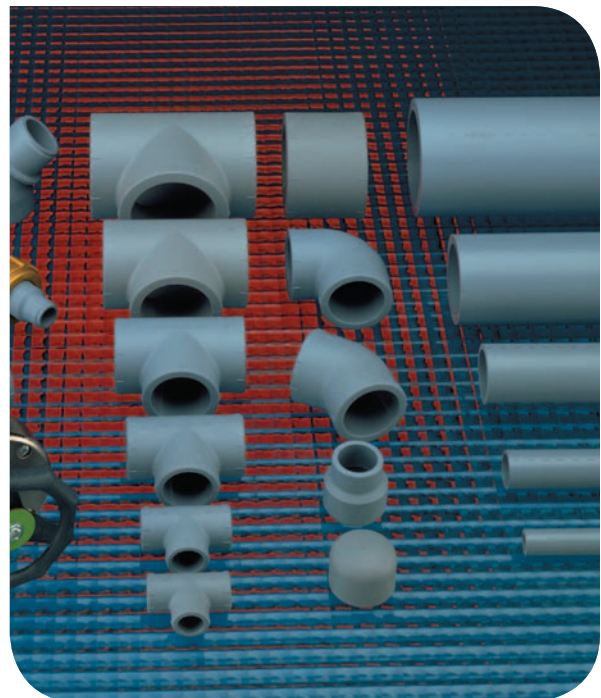
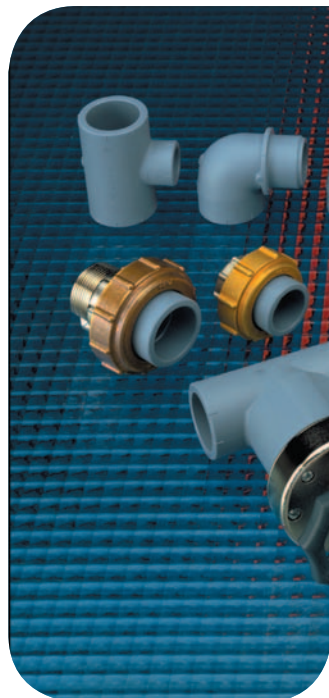

# Contents

	Page
Pipes and Accessories	6
Fittings for Socket Fusion Jointing	8
Fittings for Compression Joints	15
Manifolds and Accessories	20
Valves	21
Machines and Tools	26
Numerical Product Range	
Arranged according to catalogue number	30
Arranged according to code	34
General Conditions of Supply of Georg Fischer Building Technology Ltd	38

# General Information

## Explanation of signs

PB	Polybutylene
PE	Polyethylene
PP	Polypropylene
d	Pipe outside diameter
EPDM	Ethylene propylene rubber
s	Wall thickness of the pipe
d <sub>Cu</sub>	Copper pipe outside diameter
DN	Nominal bore
Ø	Diameter
LK	Hole circle
SW	Dimension across flats (A/F)
G	Pipe thread, not pressure tight in the thread (with flat seat) to ISO 228
R	Taper male thread, pressure tight in the thread to ISO 7
Rp	Parallel female thread, pressure tight in the thread to ISO 7
M	Metric thread to ISO 261
m	Meter
SP	Items per standard pack
g	Gramme

## Dimensions

All dimensions are given in mm and are intended as nominal or average sizes. Subject to alteration resulting from modifications in design.

SW of the compression fittings

d 16 SW = 24

d 20 SW = 27

## Compression Fittings

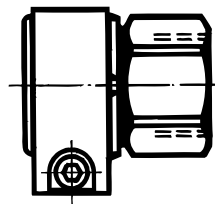

d 25 and d 32  
with one tightening strap

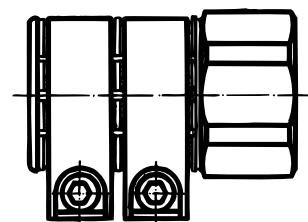

d 40, d 50, d 63, d 75  
with two tightening straps

**For compressed air applications with air containing mineral oil, EPDM gaskets must be replaced by NBR units.**

**This mainly concerns unions and flange connections.**

**NBR gaskets are not contained in this Product Range. Please contact the George Fischer sales consultant or sales support office assigned to your sales area.**

**+GF+** and **INSTAFLEX** are registered trademarks.

# Working with plastic pipes and fittings

Transport and storage of plastic pipes

**WRONG**

**RIGHT**

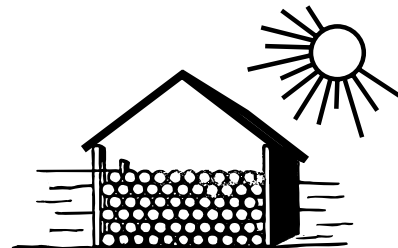
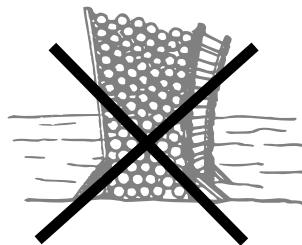
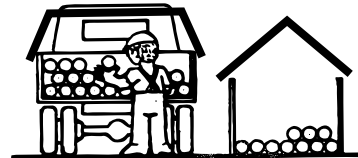
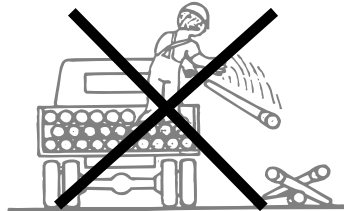
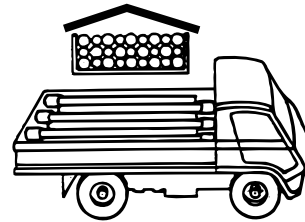
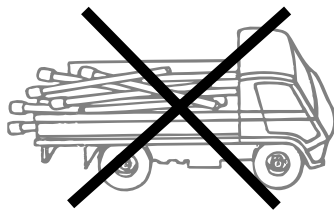

Plastics are materials sensitive to impact and crushing at low temperatures. The temperature limit depends on the relevant material.

PP-R	+5 °C
PVC-C	
PB	-10 °C

Below these temperatures pipes and fittings would have to be protected particularly from impacts, crushing and other external mechanical stresses.



Safety instruction

Plastic pipes and plastic fittings must be protected in principle from external influences. Direct sunlight, impacts and compressive stresses should be avoided. The pipes and fittings must be left in their packing until used. They should not be stored out of doors.

# Pipes in bars

3714

## Pipe PB in bars of 5,8 m

packed in cardboard boxes

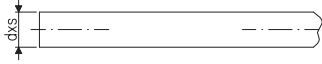

d x s	Code	SP	kg	
16x 2,2	<b>760 856 606</b>	9 x 5,8 m <sup>1</sup>	0,100	
20x 2,8	<b>760 856 607</b>	9 x 5,8 m <sup>1</sup>	0,150	
25x 2,3	<b>760 856 608</b>	10 x 5,8 m <sup>1</sup>	0,165	
32x 2,9	<b>760 856 609</b>	10 x 5,8 m <sup>1</sup>	0,270	
40x 3,7	<b>760 856 610</b>	10 x 5,8 m <sup>1</sup>	0,416	
50x 4,6	<b>760 856 611</b>	7 x 5,8 m <sup>1</sup>	0,645	
63x 5,8	<b>760 856 612</b>	7 x 5,8 m <sup>1</sup>	1,020	
75x 6,8	<b>760 856 613</b>	1 x 5,8 m <sup>1</sup>	1,440	
90x 8,2	<b>760 856 614</b>	1 x 5,8 m <sup>1</sup>	2,060	
110x10,0	<b>760 856 615</b>	1 x 5,8 m <sup>1</sup>	3,050	

# Accessories

**3931**

**Clip-carrier**

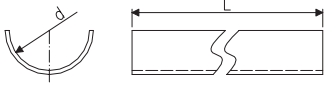

d	Code	SP	kg	L	
16	<b>760 856 602</b>	10 x 3m <sup>1</sup>	0,270	3m <sup>1</sup>	
20	<b>760 856 603</b>	10 x 3m <sup>1</sup>	0,320	3m <sup>1</sup>	
25	<b>760 856 604</b>	10 x 3m <sup>1</sup>	0,480	3m <sup>1</sup>	
32	<b>760 856 605</b>	10 x 3m <sup>1</sup>	0,600	3m <sup>1</sup>	

**3929**

**Carrier**

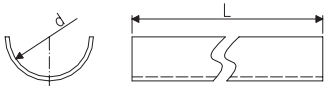

d	Code	SP	kg	L	
40	<b>760 854 928</b>	10x 3m <sup>1</sup>	0,360	3m <sup>1</sup>	
50	<b>760 854 929</b>	10x 3m <sup>1</sup>	0,450	3m <sup>1</sup>	
63	<b>760 854 930</b>	10x 3m <sup>1</sup>	0,570	3m <sup>1</sup>	
75	<b>760 854 985</b>	10x 3m <sup>1</sup>	0,680	3m <sup>1</sup>	

**3930**

**Pipe binder**

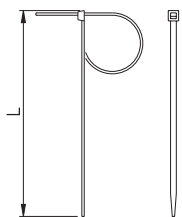

d	Code	SP	kg	L	
16- 40	<b>760 853 283</b>	100	0,001	200	
50- 75	<b>760 853 284</b>	100	0,003	300	
90-110	<b>760 854 984</b>	100	0,001	430	

# Fittings for Socket Fusion Jointing

## 5005

### Elbow 90°

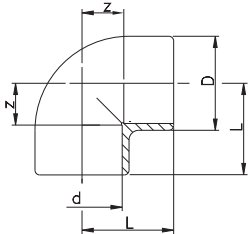

d	Code	SP	kg	L	D	z
16	<b>761 066 600</b>	10	0,014	25	22	10
20	<b>761 066 601</b>	10	0,015	28	26	13
25	<b>761 066 602</b>	10	0,026	32	32	14
32	<b>761 066 603</b>	10	0,035	38	40	18
40	<b>761 066 604</b>	10	0,076	44	51	22
50	<b>761 066 605</b>	10	0,116	51	64	26
63	<b>761 066 606</b>	2	0,239	62	81	34
75	<b>761 066 607</b>	2	0,310	75	91	44
90	<b>761 066 608</b>	2	0,500	88	108	52
110	<b>761 066 609</b>	2	0,900	105	132	63

## 5008

### Elbow 90° socket-spigot

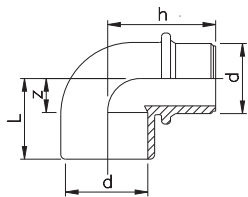

d	Code	SP	kg	L	D	h	z
16	<b>761 066 900</b>	10	0,009	25	22	34	10
20	<b>761 066 901</b>	10	0,012	28	26	36	13
25	<b>761 066 902</b>	10	0,021	32	32	44	14
32	<b>761 066 903</b>	10	0,037	38	40	50	18
40	<b>761 066 904</b>	5	0,067	44	51	58	22
50	<b>761 066 905</b>	5	0,122	51	64	70	26
63	<b>761 066 906</b>	2	0,233	62	81	82	34

## 5010

### Elbow 45°

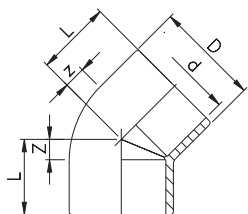

d	Code	SP	kg	L	D	z
16	<b>761 066 610</b>	10	0,008	21	22	6
20	<b>761 066 611</b>	10	0,016	22	26	7
25	<b>761 066 612</b>	10	0,026	25	32	7
32	<b>761 066 613</b>	10	0,030	30	40	10
40	<b>761 066 614</b>	5	0,064	34	51	12
50	<b>761 066 615</b>	5	0,090	39	64	14
63	<b>761 066 616</b>	2	0,145	45	81	17
75	<b>761 066 617</b>	2	0,210	51	92	20
90	<b>761 066 618</b>	2	0,430	58	109	22
110	<b>761 066 619</b>	2	0,640	68	134	26

# 5018

## Elbow 45° socket-spigot

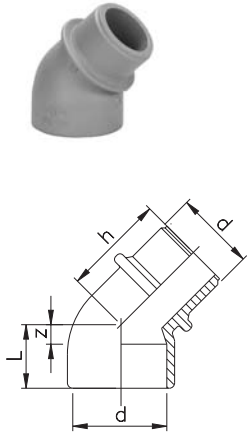

d	Code	SP	kg	L	D	h	z
16	<b>761 066 907</b>	10	0,008	21	22	29	6
20	<b>761 066 908</b>	10	0,011	22	26	30	7
25	<b>761 066 909</b>	10	0,017	25	32	35	7
32	<b>761 066 910</b>	10	0,032	30	40	40	10
40	<b>761 066 911</b>	5	0,055	34	51	46	12
50	<b>761 066 912</b>	5	0,099	39	64	53	14
63	<b>761 066 913</b>	2	0,180	45	81	62	17

# 5015

## Tee 90° equal

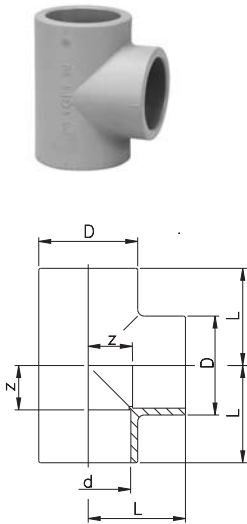

d	Code	SP	kg	L	D	z
16	<b>761 066 620</b>	10	0,017	25	22	10
20	<b>761 066 621</b>	10	0,025	28	26	13
25	<b>761 066 622</b>	10	0,036	32	32	14
32	<b>761 066 623</b>	10	0,045	38	40	18
40	<b>761 066 624</b>	10	0,105	44	51	22
50	<b>761 066 625</b>	10	0,145	51	64	26
63	<b>761 066 626</b>	5	0,315	62	81	34
75	<b>761 066 627</b>	2	0,430	75	91	44
90	<b>761 066 628</b>	2	0,750	88	112	52
110	<b>761 066 629</b>	2	1,120	105	132	63



# 5020

# Tee 90° reduced



d1-d2-d3	Code	SP	kg
20-16-20	<b>761 066 914</b>	10	0,015
20-16-16	<b>761 066 915</b>	10	0,016
20-20-16	<b>761 066 916</b>	10	0,017
25-16-25	<b>761 066 917</b>	10	0,025
25-20-25	<b>761 066 918</b>	10	0,023
25-20-20	<b>761 066 919</b>	10	0,026
25-25-20	<b>761 066 920</b>	10	0,027
32-16-32	<b>761 066 921</b>	10	0,041
32-20-32	<b>761 066 922</b>	10	0,039
32-25-32	<b>761 066 923</b>	10	0,040
40-16-40	<b>761 066 295</b>	5	0,083
40-25-40	<b>761 066 924</b>	5	0,077
50-16-50	<b>761 066 309</b>	5	0,135
50-25-50	<b>761 066 925</b>	5	0,130
63-16-63	<b>761 066 310</b>	5	0,257
63-25-63	<b>761 066 926</b>	5	0,252

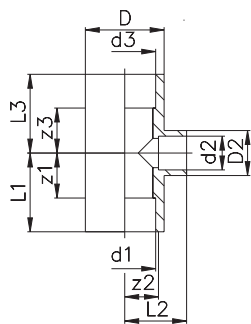

d1-d2-d3	D	D2	L1	L2	L3	z1	z2	z3
20-16-20	26	22	28	28	28	13	13	13
20-16-16	26	22	28	28	28	13	13	13
20-20-16	26	26	28	28	28	13	13	13
25-16-25	32	26	32	32	32	14	17	14
25-20-25	32	26	32	32	32	14	17	14
25-20-20	32	26	32	32	32	14	17	17
25-25-20	32	32	32	32	32	14	14	17
32-16-32	40	26	38	38	38	18	23	18
32-20-32	40	26	38	38	38	18	23	18
32-25-32	40	32	38	38	38	18	20	18
40-16-40	51	34	44	44	44	22	29	22
40-25-40	51	34	44	44	44	22	26	22
50-16-50	64	34	51	51	51	26	36	26
50-25-50	64	34	51	51	51	26	33	26
63-16-63	81	35	62	62	62	34	47	34
63-25-63	81	35	62	62	62	34	44	34

# 5040

# Socket

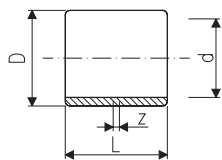

d	Code	SP	kg	L	D	z
16	<b>761 066 660</b>	10	0,009	33	22	3
20	<b>761 066 661</b>	10	0,014	33	26	3
25	<b>761 066 662</b>	10	0,020	39	32	3
32	<b>761 066 663</b>	10	0,033	43	40	3
40	<b>761 066 664</b>	10	0,048	48	51	4
50	<b>761 066 665</b>	10	0,069	54	64	4
63	<b>761 066 666</b>	2	0,120	60	81	4
75	<b>761 066 667</b>	2	0,150	69	91	7
90	<b>761 066 668</b>	2	0,250	80	110	8
110	<b>761 066 669</b>	2	0,440	94	133	10

## 5045

## Reducing bush

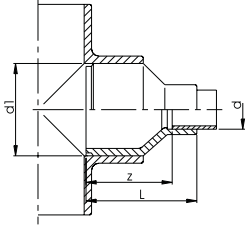

d-d1	Code	SP	kg	L	z
20-16	<b>761 066 670</b>	10	0,005	30	15
25-16	<b>761 066 671</b>	10	0,010	33	18
25-20	<b>761 066 672</b>	10	0,015	33	18
32-20	<b>761 066 674</b>	10	0,018	40	25
32-25	<b>761 066 675</b>	10	0,022	40	22
40-20	<b>761 066 677</b>	10	0,024	42	27
40-25	<b>761 066 678</b>	10	0,028	42	24
40-32	<b>761 066 679</b>	10	0,034	42	22
50-20	<b>761 066 681</b>	10	0,035	55	40
50-25	<b>761 066 682</b>	10	0,038	55	37
50-32	<b>761 066 683</b>	10	0,042	55	35
50-40	<b>761 066 684</b>	10	0,050	55	33
63-20	<b>761 066 686</b>	5	0,055	58	43
63-25	<b>761 066 687</b>	5	0,060	58	40
63-32	<b>761 066 688</b>	5	0,066	58	38
63-40	<b>761 066 689</b>	5	0,074	58	36
63-50	<b>761 066 690</b>	5	0,079	58	33
75-63	<b>761 066 742</b>	2	0,115	67	39
90-63	<b>761 066 746</b>	2	0,149	74	46
90-75	<b>761 066 745</b>	2	0,160	74	43
110-63	<b>761 066 747</b>	2	0,229	86	58
110-75	<b>761 066 749</b>	2	0,234	86	55
110-90	<b>761 066 748</b>	2	0,270	86	50

## 5050

## Cap

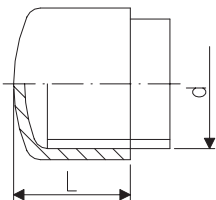

d	Code	SP	kg	L
16	<b>761 066 650</b>	10	0,006	22
20	<b>761 066 651</b>	10	0,010	24
25	<b>761 066 652</b>	10	0,014	28
32	<b>761 066 653</b>	10	0,022	32
40	<b>761 066 654</b>	10	0,024	38
50	<b>761 066 655</b>	10	0,050	44
63	<b>761 066 656</b>	5	0,079	50

## 5051

## Plug

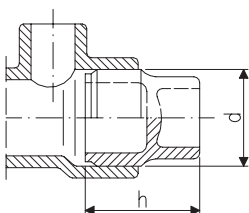

d	Code	SP	kg	h
25	<b>761 066 938</b>	10	0,008	33

5053

## Adaptor INSTAFLEX-Hepworth



d1-d2	Code	SP	kg	d	L	
16-20	<b>761 066 326</b>	10	0,005	15	54	

### Application

INSTAFLEX-Pipe  
d16 (d20)

INSTAFLEX-Socket  
Fusion Fitting  
d20 (d25)

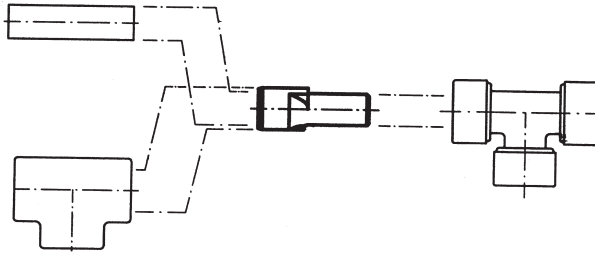

Hepworth-Fitting  
Ø 15 (Ø 22)

# Adapter on thread and valves

**6214**

## Adaptor with male thread

spigot for electrofusion male thread

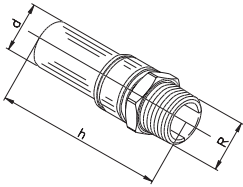

d-R	Code	SP	kg	h	
16-1/2	<b>761 069 385</b>	1	0,082	84	
20-1/2	<b>761 069 386</b>	1	0,093	86	
20-3/4	<b>761 069 387</b>	1	0,115	89	
25-3/4	<b>761 069 388</b>	1	0,134	92	
25-1	<b>761 069 389</b>	1	0,171	94	
32-1	<b>761 069 390</b>	1	0,207	94	
40-1 1/4	<b>761 069 391</b>	1	0,615	148	
50-1 1/2	<b>761 069 392</b>	1	0,930	158	
63-2	<b>761 069 393</b>	1	1,387	173	

**6215**

## Adapter with female thread

spigot for electrofusion female thread

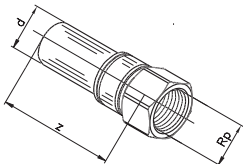

d-Rp	Code	SP	kg	z	
16-1/2	<b>761 069 360</b>	1	0,086	68	
20-1/2	<b>761 069 361</b>	1	0,099	70	
20-3/4	<b>761 069 362</b>	1	0,136	71	
25-3/4	<b>761 069 363</b>	1	0,145	72	
25-1	<b>761 069 364</b>	1	0,184	74	
32-1	<b>761 069 365</b>	1	0,209	74	
40-1 1/4	<b>761 069 366</b>	1	0,615	118	
50-1 1/2	<b>761 069 367</b>	1	0,930	124	
63-2	<b>761 069 368</b>	1	1,387	130	

**6216**

## Adapter with loose union nut, flat seal

spigot for electrofusion-female thread  
including flat seal EPDM

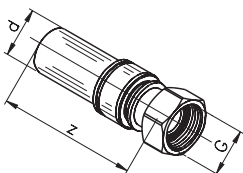

d-G	Code	SP	kg	z	
16-3/4	<b>761 069 370</b>	1	0,093	71	
20-3/4	<b>761 069 369</b>	1	0,126	84	
20-1	<b>761 069 371</b>	1	0,154	75	
25-3/4	<b>761 069 372</b>	1	0,146	87	
25-1	<b>761 069 373</b>	1	0,204	86	
25-1 1/4	<b>761 069 374</b>	1	0,231	78	
32-1	<b>761 069 375</b>	1	0,210	92	
32-1 1/4	<b>761 069 377</b>	1	0,292	87	
32-1 1/2	<b>761 069 376</b>	1	0,292	78	
40-1 1/4	<b>761 069 378</b>	1	0,510	136	
40-1 1/2	<b>761 069 379</b>	1	0,598	137	
40-2	<b>761 069 381</b>	1	0,824	141	
50-1 3/4	<b>761 069 384</b>	1	0,898	128	
50-2 1/4	<b>761 069 383</b>	1	0,820	154	
63-2 3/8	<b>761 069 394</b>	1	1,421	160	
63-2 3/4	<b>761 069 395</b>	1	0,854	137	

## 6217

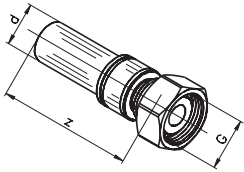

## Adaptor with loose union nut, flat seal, with centering

spigot for electrofusion - female thread  
including gasket, tesnit blue free of asbestos, according to DIN 3754

d-G	Code	SP	kg	z	
16-1/2	<b>761 069 380</b>	1	0,086	76	
20-3/4	<b>761 069 382</b>	1	0,128	78	

## 6218

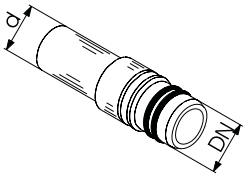

## Adaptor

for Kemper UP-Valve 56008

d-DN	Code	SP	kg	
20-15	<b>761 069 469</b>	1	0,102	
25-20	<b>761 069 470</b>	1	0,140	
32-25	<b>761 069 471</b>	1	0,209	

# Fittings for Compression Joints

**5052**

**Adaptor pipe for compression fittings**

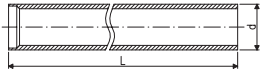

d	Code	SP	kg	L	
32	<b>761 066 712</b>	5	0,080	300	
40	<b>761 066 714</b>	5	0,130	300	
50	<b>761 066 716</b>	3	0,200	300	
63	<b>761 066 718</b>	3	0,300	300	
75	<b>761 066 308</b>	1	0,430	300	

**3301**

**Adaptor with female thread**

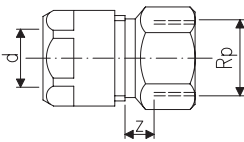

d-Rp	Code	SP	kg	z	
16-1/2	<b>760 853 104</b>	5	0,125	12	
16-3/4	<b>760 853 105</b>	5	0,128	15	
20-1/2	<b>760 853 194</b>	5	0,196	14	
20-3/4	<b>760 853 153</b>	5	0,182	16	
25-3/4	<b>760 854 735</b>	2	0,400	16	
25-1	<b>760 869 982</b>	2	0,430	16	
32-1	<b>760 854 736</b>	2	0,500	16	
40-1 1/4	<b>760 854 737</b>	1	0,780	20	
50-1 1/2	<b>760 854 738</b>	1	1,136	21	
63-2	<b>760 854 739</b>	1	1,567	21	

**3310**

**Adaptor with male thread**

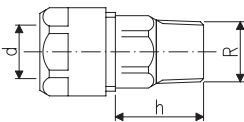

d-R	Code	SP	kg	h	
16-1/2	<b>760 853 107</b>	5	0,111	30	
16-3/4	<b>760 853 108</b>	5	0,161	34	
20-1/2	<b>760 853 195</b>	5	0,202	38	
20-3/4	<b>760 853 138</b>	5	0,222	36	
25-3/4	<b>760 854 745</b>	2	0,347	37	
25-1	<b>760 869 983</b>	2	0,400	37	
32-1	<b>760 854 746</b>	2	0,495	39	
40-1 1/4	<b>760 854 747</b>	1	0,733	46	
50-1 1/2	<b>760 854 748</b>	1	1,200	47	
63-2	<b>760 854 749</b>	1	1,480	55	
75-2 1/2	<b>760 869 992</b>	1	2,240	60	

# Union

## 5035

### Union, socket-socket

including O-Ring EPDM quality for potable water

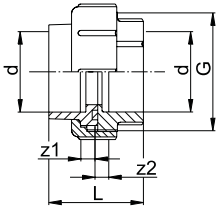

d	Code	SP	kg	L	z1	z2	G
16	<b>761 066 691</b>	10	0,135	43	8	5	1
20	<b>761 066 692</b>	10	0,150	43	8	5	1 1/4
25	<b>761 066 693</b>	10	0,200	49	8	5	1 1/2
32	<b>761 066 694</b>	5	0,295	53	8	5	2
40	<b>761 066 695</b>	5	0,450	59	10	5	2 1/2
50	<b>761 066 696</b>	2	0,560	65	10	5	2 3/4
63	<b>761 066 697</b>	2	0,900	71	10	5	3 1/2

## 5036

### Adaptor union socket-male thread

including O-Ring EPDM quality for potable water

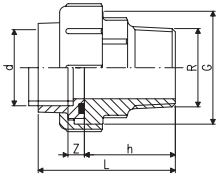

d-R	Code	SP	kg	L	h	z	G
16-1/2	<b>761 066 698</b>	10	0,262	61	38	8	1
20-1/2	<b>761 066 699</b>	10	0,150	63	40	8	1 1/4
25-3/4	<b>761 066 700</b>	10	0,320	67	41	8	1 1/2
32-1	<b>761 066 701</b>	5	0,340	73	45	8	2
40-1 1/4	<b>761 066 702</b>	5	0,560	80	48	10	2 1/2
50-1 1/2	<b>761 066 703</b>	2	0,800	83	48	10	2 3/4
63-2	<b>761 066 704</b>	2	0,900	92	54	10	3 1/2

## 5037

### Adaptor union, socket-female thread

including O-Ring EPDM quality for potable water

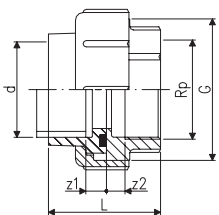

d-Rp	Code	SP	kg	L	z1	z2	G
16-1/2	<b>761 066 705</b>	10	0,207	45	8	9	1
20-1/2	<b>761 066 706</b>	10	0,120	47	8	10	1 1/4
25-3/4	<b>761 066 707</b>	10	0,280	50	8	9	1 1/2
32-1	<b>761 066 708</b>	5	0,270	53	8	8	2
40-1 1/4	<b>761 066 709</b>	5	0,600	58	10	7	2 1/2
50-1 1/2	<b>761 066 710</b>	2	0,700	61	10	7	2 3/4
63-2	<b>761 066 711</b>	2	0,720	66	10	5	3 1/2

# 6230



## Seal

suitable for adaptor union for water meter, for valves and adaptor with flat seal  
Material: EPDM

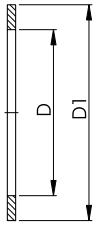

G	Code	SP	kg	D	D1	
1/2	<b>761 069 420</b>	10	0,001	13	20	
3/4	<b>761 069 421</b>	10	0,001	17	24	
1	<b>761 069 422</b>	10	0,002	21	30	
1 1/4	<b>761 069 423</b>	10	0,002	27	38	
1 1/2	<b>761 069 424</b>	10	0,003	32	44	
2	<b>761 069 425</b>	10	0,004	42	55	
2 1/4	<b>761 069 426</b>	10	0,005	46	62	
2 3/4	<b>761 069 427</b>	10	0,007	60	78	



# Flange Jointing

## 5030

### Flange adaptor flat

suitable for flange or union nut

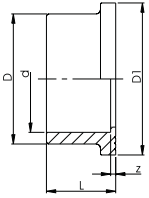

d	Code	SP	kg	L	h	D	D1	z
16	<b>761 066 630</b>	10	0,005	20	6	22	29	5
20	<b>761 066 631</b>	10	0,007	20	6	27	34	5
25	<b>761 066 632</b>	10	0,010	23	7	33	41	5
32	<b>761 066 633</b>	10	0,016	25	7	41	50	5
40	<b>761 066 634</b>	10	0,025	27	8	50	61	5
50	<b>761 066 635</b>	10	0,034	30	8	61	73	5
63	<b>761 066 636</b>	2	0,060	33	9	76	90	5
75	<b>761 066 637</b>	2	0,090	35	10	90	106	4
90	<b>761 066 638</b>	2	0,130	42	11	109	125	6
110	<b>761 066 639</b>	2	0,230	49	12	131	150	7

## 5031

### Flange adaptor with groove

suitable for flange or union nut  
including O-Ring, EPDM quality for potable water

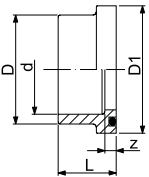

d	Code	SP	kg	L	D	D1	z
16	<b>761 066 640</b>	10	0,006	23	22	29	8
20	<b>761 066 641</b>	10	0,008	23	27	34	8
25	<b>761 066 642</b>	10	0,012	26	33	41	8
32	<b>761 066 643</b>	10	0,018	28	41	50	8
40	<b>761 066 644</b>	10	0,030	32	50	61	10
50	<b>761 066 645</b>	10	0,040	35	61	73	10
63	<b>761 066 646</b>	2	0,071	38	76	90	10
75	<b>761 066 647</b>	2	0,090	40	90	106	9
90	<b>761 066 648</b>	2	0,130	47	109	125	11
110	<b>761 066 649</b>	2	0,230	55	131	150	13

## Flange adaptor PB

## 5080

### O-Ring, EPDM quality for potable water

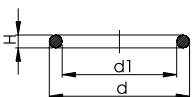

d	Code	SP	kg	d1	D	H
16	<b>761 066 738</b>	10	0,002	18.6	25.7	3.5
20	<b>761 066 720</b>	10	0,002	23.4	30.5	3.5
25	<b>761 066 721</b>	10	0,002	28.2	35.2	3.5
32	<b>761 066 722</b>	10	0,002	36.1	43.2	3.5
40	<b>761 066 723</b>	10	0,003	43.8	54.5	5.3
50	<b>761 066 724</b>	10	0,004	53.3	64.0	5.3
63	<b>761 066 725</b>	10	0,005	69.2	79.9	5.3
75	<b>761 066 952</b>	5	0,006	81.9	92.5	5.3
90	<b>761 066 953</b>	5	0,008	101	111.6	5.3
110	<b>761 066 954</b>	5	0,016	120	134	7.0

## 5085

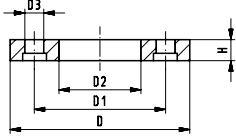

## Backing flanges

suitable for flange adaptor

Material: Casting, GFK coated

Tighten the screws with torque, as indicated

Commercially available screws, nuts, washers

d	Code	SP	kg	D	D1	D2	D3	H	AL	screws
20	<b>761 065 270</b>	2	0,400	106	65	28	14	18	4	M 12x 70
25	<b>761 065 271</b>	2	0,500	118	75	34	14	18	4	M 12x 75
32	<b>761 065 272</b>	2	0,500	122	85	42	14	17	4	M 12x 75
40	<b>761 065 273</b>	2	0,600	142	100	51	18	17	4	M 16x 80
50	<b>761 065 274</b>	2	0,800	156	110	62	18	19	4	M 16x 85
63	<b>761 065 275</b>	2	0,900	171	125	78	18	20	4	M 16x 85
75	<b>761 065 276</b>	2	1,200	191	145	92	18	21	4	M 16x 90
90	<b>761 065 277</b>	2	1,200	206	160	110	18	21	8	M 16x 90
110	<b>761 065 278</b>	2	1,500	226	180	133	18	22	8	M 16x 90

## 5087

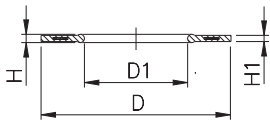

## Flange gasket

Only for adaptor metal plastic

suitable for flange adaptor flat

Material: EPDM

The gasket is designed so that it is centered by the flange screws

**D** corresponds to the centering on the inner diameter of the screw crown

d	Code	SP	kg	D	D1	H	H1
20	<b>761 066 329</b>	5	0,009	51	20	3	4
25	<b>761 066 330</b>	5	0,012	61	25	3	4
32	<b>761 066 331</b>	5	0,015	71	32	3	4
40	<b>761 066 332</b>	5	0,019	82	40	3	4
50	<b>761 066 333</b>	5	0,022	92	50	3	4
63	<b>761 066 334</b>	5	0,041	107	63	4	5
75	<b>761 066 315</b>	1	0,054	127	75	4	5
90	<b>761 066 316</b>	1	0,060	142	90	4	5
110	<b>761 066 317</b>	1	0,083	162	110	5	6

## 5081

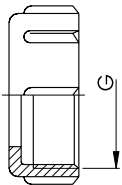

## Union nut

suitable for flange adaptor and union

d-G	Code	SP	kg
16-1	<b>761 066 980</b>	10	0,120
20-1 <sup>1</sup> / <sub>4</sub>	<b>761 066 971</b>	10	0,090
25-1 <sup>1</sup> / <sub>2</sub>	<b>761 066 972</b>	10	0,110
32-2	<b>761 066 973</b>	10	0,130
40-2 <sup>1</sup> / <sub>2</sub>	<b>761 066 974</b>	10	0,180
50-2 <sup>3</sup> / <sub>4</sub>	<b>761 066 975</b>	10	0,210
63-3 <sup>1</sup> / <sub>2</sub>	<b>761 066 976</b>	2	0,280

# Manifold and Accessories

## Manifold in Polybutylene d 25 (DN 20)

5062

### ELS Manifold PB

electrofusion connections



d-d1		Code	SP	kg
25-16	single	<b>761 066 250</b>	1	0,031
25-20	single	<b>761 066 251</b>	1	0,041
25-16	double	<b>761 066 252</b>	1	0,062
25-16	triple	<b>761 066 253</b>	1	0,092
25-16	4 fold	<b>761 066 254</b>	1	0,121

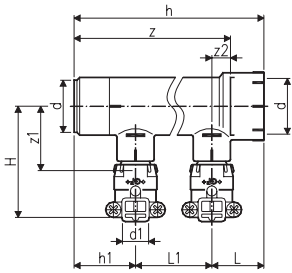

d-d1		L	L1	h	h1	H	z	z1	z2
25-16	single	31	-	63	32	60	45	36	13
25-20	single	39	-	78	39	64	60	35	21
25-16	double	31	45	108	32	60	90	36	13
25-16	triple	31	45	153	32	60	135	36	13
25-16	4 fold	31	45	198	32	60	180	36	13

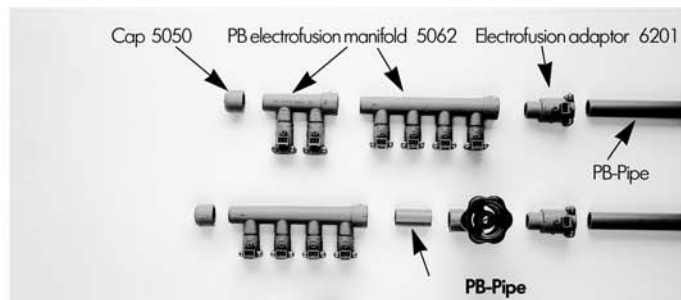
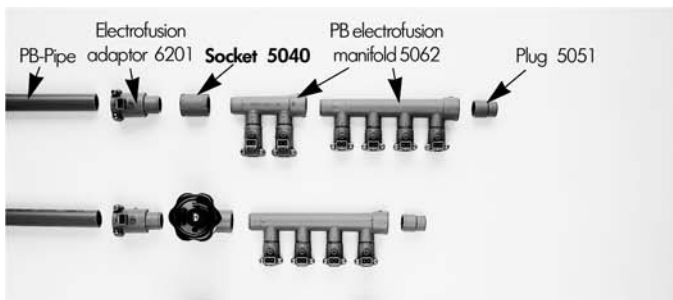

# Valves

## Valves in Polybutylene (do not use as drain valve)

**5070**

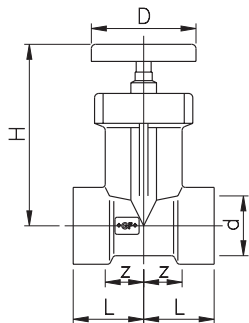

**Valve PB**

for electrofusion

Gasket: EPDM quality for potable water

Handweel antracite with green/red changeover disk

(do not use as drain valve)

d (DN)	Code	SP	kg	H	L	z	D
20 (15)	<b>761 066 284</b>	1	0,350	86	40	25	70
25 (20)	<b>761 066 958</b>	1	0,340	86	40	22	70
32 (25)	<b>761 066 959</b>	1	0,350	91	43	23	70
40 (32)	<b>761 066 289</b>	1	1,000	155	55	33	90
50 (40)	<b>761 066 290</b>	1	1,050	155	60	35	90
63 (50)	<b>761 066 291</b>	1	1,235	155	75	47	90

**5073**

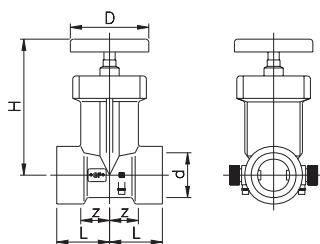

**Valve PB with spigot G 1/4" for drain**

for electrofusion

Gasket: EPDM quality for potable water

Handweel antracite with green/red changeover disk

**Drain valve must be ordered seperately**

(do not use as drain valve)

d (DN)	Code	SP	kg	H	L	z	D
20 (15)	<b>761 066 272</b>	1	0,395	86	40	25	70
25 (20)	<b>761 066 273</b>	1	0,388	86	40	22	70
32 (25)	<b>761 066 274</b>	1	0,402	91	43	23	70
40 (32)	<b>761 066 275</b>	1	1,020	155	55	33	90
50 (40)	<b>761 066 276</b>	1	1,070	155	60	35	90
63 (50)	<b>761 066 277</b>	1	1,260	155	75	47	90

## 5075



## Valve PB concealed

for finished mounting set  
for electrofusion  
Gasket: EPDM for potable water

(do not use as drain valve)

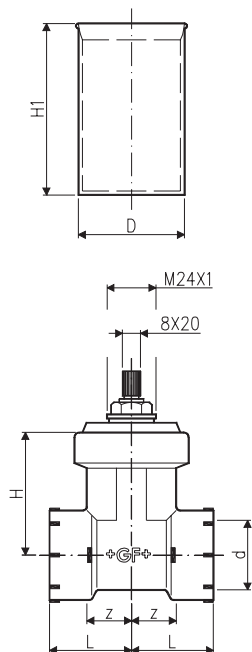

d (DN)	Code	SP	kg		
20 (15)	<b>761 066 286</b>	1	0,350	For dimensions see PB-valve	
25 (20)	<b>761 066 955</b>	1	0,340		
32 (25)	<b>761 066 956</b>	1	0,360		

## 5074



## Drain valve and plug

G	Code	SP	kg		
1/4	<b>761 066 328</b>	1	0,059		

**3419**

**Cap chromium, to valve PB concealed**

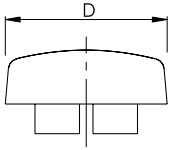

d	Code	SP	kg	D	
20 - 32	<b>760 853 786</b>	1	0,032	68	

**5096**

**Valve bracket for valve PB without drain**

for GIS or wall mounting

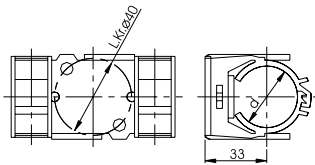

d	Code	SP	kg	
20 / 25	<b>761 066 325</b>	1	0,040	

# PB Valves

**3417**

**Sleeve for valve PB concealed**

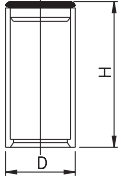

d	Code	SP	kg	D	H
20 /25 /32	<b>761 066 979</b>	1	0,030	52	82.5

**3420**

**Slide to valve PB**



d	Code	SP	kg
20-32	<b>761 066 335</b>	1	0,028
40-63	<b>761 066 336</b>	1	0,114

**5091**

**Pipe clamp**

d16 - d75 = **M8**  
d90 - d110 = **M10**

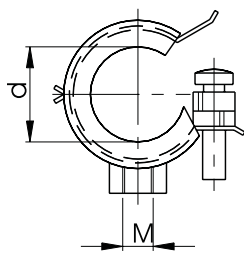

d	Code	SP	kg
16	<b>761 066 296</b>	50	0,040
20	<b>761 066 297</b>	50	0,050
25	<b>761 066 298</b>	50	0,051
32	<b>761 066 299</b>	50	0,060
40	<b>761 066 300</b>	50	0,081
50	<b>761 066 301</b>	50	0,091
63	<b>761 066 302</b>	50	0,132
75	<b>761 066 303</b>	50	0,152
90	<b>761 066 304</b>	50	0,191
110	<b>761 066 305</b>	50	0,232

## 5082

### Ball valve PVC-C / PB Flange Adaptor

no approval for potable water installation

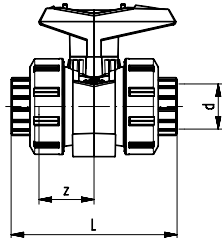

d (DN)	Code	SP	kg	L	z	
20 (15)	<b>761 066 337</b>	1	0,160	95	33	
25 (20)	<b>761 066 338</b>	1	0,245	109	36	
32 (25)	<b>761 066 339</b>	1	0,365	118	39	
40 (32)	<b>761 066 340</b>	1	0,660	137	47	
50 (40)	<b>761 066 341</b>	1	0,890	147	48	
63 (50)	<b>761 066 342</b>	1	1,650	168	46	

## 5088

### Ball valve PP / PB Flange Adaptor

no approval for potable water installation

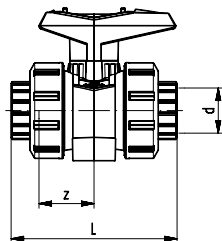

d (DN)	Code	SP	kg	L	z	
20 (15)	<b>760 000 337</b>	1	0,115	95	33	
25 (20)	<b>760 000 338</b>	1	0,180	109	36	
32 (25)	<b>760 000 339</b>	1	0,255	118	39	
40 (32)	<b>760 000 340</b>	1	0,440	137	47	
50 (40)	<b>760 000 341</b>	1	0,610	147	48	
63 (50)	<b>760 000 342</b>	1	1,145	168	46	

## 5084

### PB Flange Adaptor

suitable to ball valve 5082/5088

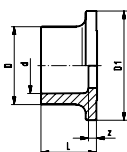

d	Code	SP	kg	L	h	D	D1	z	
20	<b>761 066 940</b>	10	0,007	20	6	27	34	5	
25	<b>761 066 941</b>	10	0,010	23	7	33	41	5	
32	<b>761 066 942</b>	10	0,016	25	7	41	50	5	
40	<b>761 066 943</b>	10	0,025	27	8	50	61	5	
50	<b>761 066 944</b>	10	0,034	30	8	61	73	5	
63	<b>761 066 945</b>	10	0,060	33	9	76	90	5	



# Machines and Tools for Socket Fusion Jointing

**5100**

## Heating element, complete 230V



consisting of: Metal case, Heating element with electronic temperature regulation Voltage 230 Volt, Power 800W, Heating bushes d16-d63, Tempil sticks 253°C and 274°C, Timer, Template, Gloves, Support, Grip, Pipe shears, Pipe cutter d32-d63, Chamfering tool d25-d63.

d	Code	SP	kg		
16-63	<b>761 066 802</b>	1	11,300		

**5120**

## Socket fusion machine

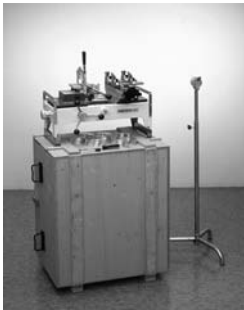

consisting of: packed on wooden case, to use as working table, prism clamp device for pipes, round clamping units for fittings d16-d63, pipe support adjustable,

**without heating element**

d	Code	SP	kg		
16-63	<b>761 066 841</b>	1	55,000		

**5121**

## Heating bushes set



consisting of: Metal case, Heating bushes d16-d63, Tempil sticks 253°C and 274°C, Timer, Template, Gloves, Instruction for socket fusion jointing

d	Code	SP	kg		
16-63	<b>761 066 754</b>	1	6,470		

**5101**

## Heating element 230V



consisting of: electronic temperature regulation, Voltage 230V, Power 800W, Instruction for the socket fusion jointing

Execution with 110V on request

d	Code	SP	kg		
16-63	<b>761 066 804</b>	1	1,550		

## 5102



### Support

for heating element

	Code	SP	kg	
	761 066 801	1	0,970	

## 5110



### Metal case, empty

for heating element and accessories

	Code	SP	kg	
	761 066 752	1	4,150	

## 5130



### Heating bushes

The INSTAFLEX heating bushes used for jointing Polybutene d75, d110 are also available at Georg Fischer

d	Code	SP	kg	
16	761 066 756	1	0,080	
20	761 066 757	1	0,120	
25	761 066 758	1	0,150	
32	761 066 759	1	0,210	
40	761 066 760	1	0,310	
50	761 066 761	1	0,450	
63	761 066 762	1	0,600	

### Special cleaner KS Tangit



	Code	SP	kg	
	799 298 023	1	0,890	

**3908****Pipe shears**

d	Code	SP	kg
16-25	<b>760 853 279</b>	1	0,269

**5300****Pipe cutter**

d	Code	SP	kg
32- 63	<b>761 066 792</b>	1	0,700
75-110	<b>761 066 834</b>	1	1,430

**5301****Spare blades for Pipe cutter**

d	Code	SP	kg
32- 63	<b>761 066 793</b>	1	0,005
75-110	<b>761 066 835</b>	1	0,010

**5302****Chamfering tool**

d	Code	SP	kg
25- 63	<b>761 066 794</b>	1	0,780
75-110	<b>761 066 836</b>	1	0,830

**5303****Spare blades for Chamfering tool**

d	Code	SP	kg
25-110	<b>761 066 795</b>	1	0,030

**5310****Tempil sticks**

	Code	SP	kg	
253 °C	<b>761 066 796</b>	1	0,010	
274 °C	<b>761 066 797</b>	1	0,020	

**5312****Timer**

	Code	SP	kg	
	<b>761 066 798</b>	1	0,042	

**5320****Gloves**

	Code	SP	kg	
	<b>761 066 799</b>	1	0,115	

**5314****Template, compression and fusion joints**

d	Code	SP	kg	
16-63	<b>761 066 800</b>	1	0,040	

**3948****Spanner**

tool to change the heating bushes



SW	Code	SP	kg	
5/6	<b>760 854 906</b>	1	0,070	

# Numerical Product Range

## Arranged according to catalogue number

CATALOGUE NUMBER	DIMENSION	SP	PAGE	CODE	ARTICLE
3301	16-1/2	5	15	760 853 104	ADAPTOR
3301	16-3/4	5	15	760 853 105	ADAPTOR
3301	20-1/2	5	15	760 853 194	ADAPTOR
3301	20-3/4	5	15	760 853 153	ADAPTOR
3301	25-3/4	2	15	760 854 735	ADAPTOR
3301	25-1	2	15	760 869 982	ADAPTOR
3301	32-1	2	15	760 854 736	ADAPTOR
3301	40-11/4	1	15	760 854 737	ADAPTOR
3301	50-11/2	1	15	760 854 738	ADAPTOR
3301	63-2	1	15	760 854 738	ADAPTOR
3310	16-1/2	5	15	760 853 107	ADAPTOR
3310	16-3/4	5	15	760 853 108	ADAPTOR
3310	20-1/2	5	15	760 853 195	ADAPTOR
3310	20-3/4	5	15	760 853 138	ADAPTOR
3310	25-3/4	2	15	760 853 745	ADAPTOR
3310	25-1	2	15	760 869 983	ADAPTOR
3310	32-1	2	15	760 854 746	ADAPTOR
3310	40-11/4	1	15	760 854 747	ADAPTOR
3310	50-11/2	1	15	760 854 748	ADAPTOR
3310	63-2	1	15	760 854 749	ADAPTOR
3310	75-21/2	1	15	760 869 992	ADAPTOR
3417	25/32	1	24	761 066 979	SLEEVE VALVE PB
3419	1	1	23	760 853 786	CAP CHROMIUM PLATED
3420	20-32	1	24	761 066 335	SLIDE TO VALVE PB
3420	40-63	1	24	761 066 336	SLIDE TO VALVE PB
3714	16X2,2	9X5,8 M	6	760 856 606	PIPE PB
3714	20X2,8	9X5,8 M	6	760 856 607	PIPE PB
3714	25X2,3	10X5,8 M	6	760 856 608	PIPE PB
3714	32X2,9	10X5,8 M	6	760 856 609	PIPE PB
3714	40X3,7	10X5,8 M	6	760 856 610	PIPE PB
3714	50X4,6	7X5,8 M	6	760 856 611	PIPE PB
3714	63X5,8	7X5,8 M	6	760 856 612	PIPE PB
3714	75X6,8	1X5,8 M	6	760 856 613	PIPE PB
3714	90X8,2	1X5,8 M	6	760 856 614	PIPE PB
3714	110X10,0	1X5,8 M	6	760 856 615	PIPE PB
3908	16-25	1	28	760 853 279	PIPE SHEARS
3929	40 X3M	10X3 M	7	760 854 928	CARRIER
3929	50 X3M	10X3 M	7	760 854 929	CARRIER
3929	63 X3M	10X3 M	7	760 854 930	CARRIER
3929	75 X3M	10X3 M	7	760 854 985	CARRIER
3930	200	100	7	760 853 283	PIPE BINDER
3930	300	100	7	760 853 284	PIPE BINDER
3930	430	100	7	760 854 984	PIPE BINDER
3931	16	10X3 M	7	760 856 602	CLIP-CARRIER
3931	20	10X3 M	7	760 856 603	CLIP-CARRIER
3931	25	10X3 M	7	760 856 604	CLIP-CARRIER
3931	32	10X3 M	7	760 856 605	CLIP-CARRIER
3948	5/6	1	29	760 854 906	FASTENING SLEEVE
5005	16	10	8	761 066 600	ELBOW 90
5005	20	10	8	761 066 601	ELBOW 90
5005	25	10	8	761 066 602	ELBOW 90
5005	32	10	8	761 066 603	ELBOW 90
5005	40	10	8	761 066 604	ELBOW 90
5005	50	10	8	761 066 605	ELBOW 90
5005	63	2	8	761 066 606	ELBOW 90
5005	75	2	8	761 066 607	ELBOW 90
5005	90	2	8	761 066 608	ELBOW 90
5005	110	2	8	761 066 609	ELBOW 90
5008	16	10	8	761 066 900	ELBOW 90 SOCKET-SPIGOT
5008	20	10	8	761 066 901	ELBOW 90 SOCKET-SPIGOT
5008	25	10	8	761 066 902	ELBOW 90 SOCKET-SPIGOT
5008	32	10	8	761 066 903	ELBOW 90 SOCKET-SPIGOT
5008	40	5	8	761 066 904	ELBOW 90 SOCKET-SPIGOT
5008	50	5	8	761 066 905	ELBOW 90 SOCKET-SPIGOT
5008	63	2	8	761 066 906	ELBOW 90 SOCKET-SPIGOT
5010	16	10	8	761 066 610	ELBOW 45
5010	20	10	8	761 066 611	ELBOW 45
5010	25	10	8	761 066 612	ELBOW 45
5010	32	10	8	761 066 613	ELBOW 45
5010	40	5	8	761 066 614	ELBOW 45
5010	50	5	8	761 066 615	ELBOW 45
5010	63	2	8	761 066 616	ELBOW 45
5010	75	2	8	761 066 617	ELBOW 45
5010	90	2	8	761 066 618	ELBOW 45
5010	110	2	8	761 066 619	ELBOW 45
5015	16	10	9	761 066 620	TEE 90 EQUAL
5015	20	10	9	761 066 621	TEE 90 EQUAL
5015	25	10	9	761 066 622	TEE 90 EQUAL
5015	32	10	9	761 066 623	TEE 90 EQUAL
5015	40	10	9	761 066 624	TEE 90 EQUAL
5015	50	10	9	761 066 625	TEE 90 EQUAL
5015	63	5	9	761 066 626	TEE 90 EQUAL
5015	75	2	9	761 066 627	TEE 90 EQUAL
5015	90	2	9	761 066 628	TEE 90 EQUAL
5015	110	2	9	761 066 629	TEE 90 EQUAL
5018	16	10	9	761 066 907	ELBOW 45 SOCKET-SPIGOT
5018	20	10	9	761 066 908	ELBOW 45 SOCKET-SPIGOT
5018	25	10	9	761 066 909	ELBOW 45 SOCKET-SPIGOT
5018	32	10	9	761 066 910	ELBOW 45 SOCKET-SPIGOT
5018	40	5	9	761 066 911	ELBOW 45 SOCKET-SPIGOT

CATALOGUE NUMBER	DIMENSION	SP	PAGE	CODE	ARTICLE
5018	50	5	9	761 066 912	ELBOW 45 SOCKET-SPIGOT
5018	63	2	9	761 066 913	ELBOW 45 SOCKET-SPIGOT
5020	20-16-16	10	10	761 066 915	TEE 90 REDUCED
5020	20-16-20	10	10	761 066 914	TEE 90 REDUCED
5020	20-20-16	10	10	761 066 916	TEE 90 REDUCED
5020	25-16-25	10	10	761 066 917	TEE 90 REDUCED
5020	25-20-20	10	10	761 066 919	TEE 90 REDUCED
5020	25-20-25	10	10	761 066 918	TEE 90 REDUCED
5020	25-25-20	10	10	761 066 920	TEE 90 REDUCED
5020	32-16-32	10	10	761 066 921	TEE 90 REDUCED
5020	32-20-32	10	10	761 066 922	TEE 90 REDUCED
5020	32-25-32	10	10	761 066 923	TEE 90 REDUCED
5020	40-16-40	5	10	761 066 295	TEE 90 REDUCED
5020	40-25-40	5	10	761 066 924	TEE 90 REDUCED
5020	50-16-50	5	10	761 066 309	TEE 90 REDUCED
5020	50-25-50	5	10	761 066 925	TEE 90 REDUCED
5020	63-16-63	5	10	761 066 310	TEE 90 REDUCED
5020	63-25-63	5	10	761 066 926	TEE 90 REDUCED
5030	16	10	18	761 066 630	FLANGE ADAPTOR FLAT
5030	20	10	18	761 066 631	FLANGE ADAPTOR FLAT
5030	25	10	18	761 066 632	FLANGE ADAPTOR FLAT
5030	32	10	18	761 066 633	FLANGE ADAPTOR FLAT
5030	40	10	18	761 066 634	FLANGE ADAPTOR FLAT
5030	50	10	18	761 066 635	FLANGE ADAPTOR FLAT
5030	63	2	18	761 066 636	FLANGE ADAPTOR FLAT
5030	75	2	18	761 066 637	FLANGE ADAPTOR FLAT
5030	90	2	18	761 066 638	FLANGE ADAPTOR FLAT
5030	110	2	18	761 066 639	FLANGE ADAPTOR FLAT
5031	16	10	18	761 066 640	FLANGE ADAPTOR WITH GROOVE
5031	20	10	18	761 066 641	FLANGE ADAPTOR WITH GROOVE
5031	25	10	18	761 066 642	FLANGE ADAPTOR WITH GROOVE
5031	32	10	18	761 066 643	FLANGE ADAPTOR WITH GROOVE
5031	40	10	18	761 066 644	FLANGE ADAPTOR WITH GROOVE
5031	50	10	18	761 066 645	FLANGE ADAPTOR WITH GROOVE
5031	63	2	18	761 066 646	FLANGE ADAPTOR WITH GROOVE
5031	75	2	18	761 066 647	FLANGE ADAPTOR WITH GROOVE
5031	90	2	18	761 066 648	FLANGE ADAPTOR WITH GROOVE
5031	110	2	18	761 066 649	FLANGE ADAPTOR WITH GROOVE
5035	16	10	16	761 066 691	UNION
5035	20	10	16	761 066 692	UNION
5035	25	10	16	761 066 693	UNION
5035	32	5	16	761 066 694	UNION
5035	40	5	16	761 066 695	UNION
5035	50	2	16	761 066 696	UNION
5035	63	2	16	761 066 697	UNION
5036	16-1/2	10	16	761 066 698	ADAPTOR UNION
5036	20-1/2	10	16	761 066 699	ADAPTOR UNION
5036	25-3/4	10	16	761 066 700	ADAPTOR UNION
5036	32-1	5	16	761 066 701	ADAPTOR UNION
5036	40-11/4	5	16	761 066 702	ADAPTOR UNION
5036	50-11/2	2	16	761 066 703	ADAPTOR UNION
5036	63-2	2	16	761 066 704	ADAPTOR UNION
5037	16-1/2	10	16	761 066 705	ADAPTOR UNION
5037	20-1/2	10	16	761 066 706	ADAPTOR UNION
5037	25-3/4	10	16	761 066 707	ADAPTOR UNION
5037	32-1	5	16	761 066 708	ADAPTOR UNION
5037	40-11/4	5	16	761 066 709	ADAPTOR UNION
5037	50-11/2	2	16	761 066 710	ADAPTOR UNION
5037	63-2	2	16	761 066 711	ADAPTOR UNION
5040	16	10	10	761 066 660	SOCKET
5040	20	10	10	761 066 661	SOCKET
5040	25	10	10	761 066 662	SOCKET
5040	32	10	10	761 066 663	SOCKET
5040	40	10	10	761 066 664	SOCKET
5040	50	10	10	761 066 665	SOCKET
5040	63	2	10	761 066 666	SOCKET
5040	75	2	10	761 066 667	SOCKET
5040	90	2	10	761 066 668	SOCKET
5040	110	2	10	761 066 669	SOCKET
5045	20-16	10	11	761 066 670	REDUCING BUSH
5045	25-16	10	11	761 066 671	REDUCING BUSH
5045	25-20	10	11	761 066 672	REDUCING BUSH
5045	32-20	10	11	761 066 674	REDUCING BUSH
5045	32-25	10	11	761 066 675	REDUCING BUSH
5045	40-20	10	11	761 066 677	REDUCING BUSH
5045	40-25	10	11	761 066 678	REDUCING BUSH
5045	40-32	10	11	761 066 679	REDUCING BUSH
5045	50-20	10	11	761 066 681	REDUCING BUSH
5045	50-25	10	11	761 066 682	REDUCING BUSH
5045	50-32	10	11	761 066 683	REDUCING BUSH
5045	50-40	10	11	761 066 684	REDUCING BUSH
5045	63-20	5	11	761 066 686	REDUCING BUSH
5045	63-25	5	11	761 066 687	REDUCING BUSH
5045	63-32	5	11	761 066 688	REDUCING BUSH
5045	63-40	5	11	761 066 689	REDUCING BUSH
5045	63-50	5	11	761 066 690	REDUCING BUSH
5045	75-63	2	11	761 066 742	REDUCING BUSH
5045	90-63	2	11	761 066 746	REDUCING BUSH
5045	90-75	2	11	761 066 745	REDUCING BUSH
5045	110-63	2	11	761 066 747	REDUCING BUSH
5045	110-75	2	11	761 066 749	REDUCING BUSH
5045	110-90	2	11	761 066 748	REDUCING BUSH
5050	16	10	11	761 066 650	CAP
5050	20	10	11	761 066 651	CAP
5050	25	10	11	761 066 652	CAP
5050	32	10	11	761 066 653	CAP
5050	40	10	11	761 066 654	CAP
5050	50	10	11	761 066 655	CAP
5050	63	5	11	761 066 656	CAP
5051	25	10	11	761 066 938	PLUG

CATALOGUE NUMBER	DIMENSION	SP	PAGE	CODE	ARTICLE
5052	32	5	15	761 066 712	ADAPTOR PIPE
5052	40	5	15	761 066 714	ADAPTOR PIPE
5052	50	3	15	761 066 716	ADAPTOR PIPE
5052	63	3	15	761 066 718	ADAPTOR PIPE
5052	75	1	15	761 066 308	ADAPTOR PIPE
5053	16/20-Ø15	10	12	761 066 326	ADAPTOR
5062	25-16	1	20	761 066 250	MANIFOLD PB SINGLE
5062	25-20	1	20	761 066 251	MANIFOLD PB SINGLE
5062	25-16	1	20	761 066 252	MANIFOLD PB DOUBLE
5062	25-16	1	20	761 066 253	MANIFOLD PB TRIPLE
5062	25-16	1	20	761 066 254	MANIFOLD PB 4 FOLD
5070	20	1	21	761 066 284	VALVE PB
5070	20	1	21	761 066 958	VALVE PB
5070	32	1	21	761 066 959	VALVE PB
5070	40	1	21	761 066 289	VALVE PB
5070	50	1	21	761 066 290	VALVE PB
5070	63	1	21	761 066 291	VALVE PB
5073	20	1	21	761 066 272	VALVE PB WITH DRAIN
5073	25	1	21	761 066 273	VALVE PB WITH DRAIN
5073	32	1	21	761 066 274	VALVE PB WITH DRAIN
5073	40	1	21	761 066 275	VALVE PB WITH DRAIN
5073	50	1	21	761 066 276	VALVE PB WITH DRAIN
5073	63	1	21	761 066 277	VALVE PB WITH DRAIN
5074	1/4	1	22	761 066 328	DRAIN VALVE WITH PLUG
5075	20	1	22	761 066 286	VALVE PB CONCEALED
5075	25	1	22	761 066 955	VALVE PB CONCEALED
5075	32	1	22	761 066 956	VALVE PB CONCEALED
5080	16	10	18	761 066 738	O-RING
5080	20	10	18	761 066 720	O-RING
5080	25	10	18	761 066 721	O-RING
5080	32	10	18	761 066 722	O-RING
5080	40	10	18	761 066 723	O-RING
5080	50	10	18	761 066 724	O-RING
5080	63	10	18	761 066 725	O-RING
5080	75	5	18	761 066 952	O-RING
5080	90	5	18	761 066 953	O-RING
5080	110	5	18	761 066 954	O-RING
5081	16-1	10	19	761 066 980	UNION NUT
5081	20-11/4	10	19	761 066 971	UNION NUT
5081	25-11/2	10	19	761 066 972	UNION NUT
5081	32-2	10	19	761 066 973	UNION NUT
5081	40-21/2	10	19	761 066 974	UNION NUT
5081	50-23/4	10	19	761 066 975	UNION NUT
5081	63-31/2	2	19	761 066 976	UNION NUT
5082	20	1	25	761 066 337	BALL VALVE PVC-C
5082	25	1	25	761 066 338	BALL VALVE PVC-C
5082	32	1	25	761 066 339	BALL VALVE PVC-C
5082	40	1	25	761 066 340	BALL VALVE PVC-C
5082	50	1	25	761 066 341	BALL VALVE PVC-C
5082	63	1	25	761 066 342	BALL VALVE PVC-C
5084	20	1	25	761 066 940	PB FLANGE ADAPTOR
5084	25	1	25	761 066 941	PB FLANGE ADAPTOR
5084	32	1	25	761 066 942	PB FLANGE ADAPTOR
5084	40	1	25	761 066 943	PB FLANGE ADAPTOR
5084	50	1	25	761 066 944	PB FLANGE ADAPTOR
5084	63	1	25	761 066 945	PB FLANGE ADAPTOR
5085	20	2	19	761 065 270	BACKING FLANGES
5085	25	2	19	761 065 271	BACKING FLANGES
5085	32	2	19	761 065 272	BACKING FLANGES
5085	40	2	19	761 065 273	BACKING FLANGES
5085	50	2	19	761 065 274	BACKING FLANGES
5085	63	2	19	761 065 275	BACKING FLANGES
5085	75	2	19	761 065 276	BACKING FLANGES
5085	90	2	19	761 065 277	BACKING FLANGES
5085	110	2	19	761 065 278	BACKING FLANGES
5087	20	5	19	761 066 329	FLANGE GASKET
5087	25	5	19	761 066 330	FLANGE GASKET
5087	32	5	19	761 066 331	FLANGE GASKET
5087	40	5	19	761 066 332	FLANGE GASKET
5087	50	5	19	761 066 333	FLANGE GASKET
5087	63	5	19	761 066 334	FLANGE GASKET
5087	75	1	19	761 066 315	FLANGE GASKET
5087	90	1	19	761 066 316	FLANGE GASKET
5087	110	1	19	761 066 317	FLANGE GASKET
5088	20	1	25	760 000 337	BALL VALVE PP
5088	25	1	25	760 000 338	BALL VALVE PP
5088	32	1	25	760 000 339	BALL VALVE PP
5088	40	1	25	760 000 340	BALL VALVE PP
5088	50	1	25	760 000 341	BALL VALVE PP
5088	63	1	25	760 000 342	BALL VALVE PP
5096	25	1	23	761 066 325	VALVE BRACKET
5100	16-63	1	26	761 066 802	HEATING ELEMENT COMPLETE 230V
5100	16-63	1	26	761 066 750	HEATING ELEMENT COMPLETE (CHI)
5101	16-63	1	26	761 066 804	HEATING ELEMENT
5101	16-63	1	26	761 066 751	HEATING ELEMENT (CHI)
5120	16-63	1	26	761 066 841	SOCKET FUSION MACHINE
5121	16-63	1	26	761 066 754	HEATING BUSHES SET
5102		1	27	761 066 801	SUPPORT
5110		1	27	761 066 752	METAL CASE EMPTY
5130		1	27	761 066 756	HEATING BUSHES PAIR
5130		1	27	761 066 757	HEATING BUSHES PAIR
5130		1	27	761 066 758	HEATING BUSHES PAIR
5130		1	27	761 066 759	HEATING BUSHES PAIR
5130		1	27	761 066 760	HEATING BUSHES PAIR
5130		1	27	761 066 761	HEATING BUSHES PAIR
5130		1	27	761 066 762	HEATING BUSHES PAIR
5300	32-63	1	28	761 066 792	PIPE CUTTER
5300	75-100	1	28	761 066 834	PIPE CUTTER
5301	32-63	1	28	761 066 793	SPARE BLADES FOR 5300
5301	75-100	1	28	761 066 835	SPARE BLADES FOR 5300

CATALOGUE NUMBER	DIMENSION	SP	PAGE	CODE	ARTICLE
5302	25-63	1	28	761 066 794	CHAMPFERING TOOL
5302	75-100	1	28	761 066 836	CHAMPFERING TOOL
5303	25-110	1	28	761 066 795	SPARE BLADES FOR 5302
5310	253°C	1	29	761 066 796	TEMPIL STICK
5310	274°C	1	29	761 066 797	TEMPIL STICK
5312		1	29	761 066 798	TIMER
5314	16-63	1	29	761 066 800	TEMPLATE
5320		1	29	761 066 799	GLOVES
6214	16-1/2	1	13	761 069 385	ADAPTOR
6214	20-1/2	1	13	761 069 386	ADAPTOR
6214	20-3/4	1	13	761 069 387	ADAPTOR
6214	25-3/4	1	13	761 069 388	ADAPTOR
6214	25-1	1	13	761 069 389	ADAPTOR
6214	32-1	1	13	761 069 390	ADAPTOR
6214	40-11/4	1	13	761 069 391	ADAPTOR
6214	50-11/2	1	13	761 069 392	ADAPTOR
6214	63-2	1	13	761 069 393	ADAPTOR
6215	16-1/2	1	13	761 069 360	ADAPTOR
6215	20-1/2	1	13	761 069 361	ADAPTOR
6215	20-3/4	1	13	761 069 362	ADAPTOR
6215	25-3/4	1	13	761 069 363	ADAPTOR
6215	25-1	1	13	761 069 364	ADAPTOR
6215	32-1	1	13	761 069 365	ADAPTOR
6215	40-11/4	1	13	761 069 366	ADAPTOR
6215	50-11/2	1	13	761 069 367	ADAPTOR
6215	63-2	1	13	761 069 368	ADAPTOR
6216	16-3/4	1	13	761 069 370	ADAPTOR
6216	20-3/4	1	13	761 069 369	ADAPTOR
6216	20-1	1	13	761 069 371	ADAPTOR
6216	25-3/4	1	13	761 069 372	ADAPTOR
6216	25-1	1	13	761 069 373	ADAPTOR
6216	25-11/4	1	13	761 069 374	ADAPTOR
6216	32-1	1	13	761 069 375	ADAPTOR
6216	32-11/4	1	13	761 069 377	ADAPTOR
6216	32-11/2	1	13	761 069 376	ADAPTOR
6216	40-11/4	1	13	761 069 378	ADAPTOR
6216	40-11/2	1	13	761 069 379	ADAPTOR
6216	40-2	1	13	761 069 381	ADAPTOR
6216	50-13/4	1	13	761 069 384	ADAPTOR
6216	50-21/4	1	13	761 069 383	ADAPTOR
6216	63-23/8	1	13	761 069 394	ADAPTOR
6216	63-23/4	1	13	761 069 395	ADAPTOR
6217	16-1/2	1	14	761 069 380	ADAPTOR
6217	20-3/4	1	14	761 069 382	ADAPTOR
6218	20-15	1	14	761 069 469	ADAPTOR
6218	25-20	1	14	761 069 470	ADAPTOR
6218	32-25	1	14	761 069 471	ADAPTOR
6230	1/2	10	17	761 069 420	SEAL
6230	3/4	10	17	761 069 421	SEAL
6230	1	10	17	761 069 422	SEAL
6230	11/4	10	17	761 069 423	SEAL
6230	11/2	10	17	761 069 424	SEAL
6230	2	10	17	761 069 425	SEAL
6230	21/4	10	17	761 069 426	SEAL
6230	23/4	10	17	761 069 427	SEAL
		1	27	799 298 023	SPECIAL CLEANER TANGIT



# Numerical Product Range

## Arranged according to code

CATALOGUE NUMBER	DIMENSION	SP	PAGE	CODE	ARTICLE
5088	20	1	25	760 000 337	BALL VALVE PP
5088	25	1	25	760 000 338	BALL VALVE PP
5088	32	1	25	760 000 339	BALL VALVE PP
5088	40	1	25	760 000 340	BALL VALVE PP
5088	50	1	25	760 000 341	BALL VALVE PP
5088	63	1	25	760 000 342	BALL VALVE PP
3301	16-1/2	5	15	760 853 104	ADAPTOR
3301	16-3/4	5	15	760 853 105	ADAPTOR
3310	16-1/2	5	15	760 853 107	ADAPTOR
3310	16-3/4	5	15	760 853 108	ADAPTOR
3310	20-3/4	5	15	760 853 138	ADAPTOR
3301	20-3/4	5	15	760 853 153	ADAPTOR
3301	20-1/2	5	15	760 853 194	ADAPTOR
3310	20-1/2	5	15	760 853 195	ADAPTOR
3908	16-25	1	28	760 853 279	PIPE SHEARS
3930	200	100	7	760 853 283	PIPE BINDER
3930	300	100	7	760 853 284	PIPE BINDER
3310	25-3/4	2	15	760 853 745	ADAPTOR
3419	1	1	23	760 853 786	CAP CHROMIUM PLATED
3301	25-3/4	2	15	760 854 735	ADAPTOR
3301	32-1	2	15	760 854 736	ADAPTOR
3301	40-1 1/4	1	15	760 854 737	ADAPTOR
3301	50-1 1/2	1	15	760 854 738	ADAPTOR
3301	63-2	1	15	760 854 738	ADAPTOR
3310	32-1	2	15	760 854 746	ADAPTOR
3310	40-1 1/4	1	15	760 854 747	ADAPTOR
3310	50-1 1/2	1	15	760 854 748	ADAPTOR
3310	63-2	1	15	760 854 749	ADAPTOR
3948	5/6	1	29	760 854 906	FASTENING SLEEVE
3929	40 X3M	10X3 M	7	760 854 928	CARRIER
3929	50 X3M	10X3 M	7	760 854 929	CARRIER
3929	63 X3M	10X3 M	7	760 854 930	CARRIER
3930	430	100	7	760 854 984	PIPE BINDER
3929	75 X3M	10X3 M	7	760 854 985	CARRIER
3931	16	10X3 M	7	760 856 602	CLIP-CARRIER
3931	20	10X3 M	7	760 856 603	CLIP-CARRIER
3931	25	10X3 M	7	760 856 604	CLIP-CARRIER
3931	32	10X3 M	7	760 856 605	CLIP-CARRIER
3714	16X2,2	9X5,8 M	6	760 856 606	PIPE PB
3714	20X2,8	9X5,8 M	6	760 856 607	PIPE PB
3714	25X2,3	10X5,8 M	6	760 856 608	PIPE PB
3714	32X2,9	10X5,8 M	6	760 856 609	PIPE PB
3714	40X3,7	10X5,8 M	6	760 856 610	PIPE PB
3714	50X4,6	7X5,8 M	6	760 856 611	PIPE PB
3714	63X5,8	7X5,8 M	6	760 856 612	PIPE PB
3714	75X6,8	1X5,8 M	6	760 856 613	PIPE PB
3714	90X8,2	1X5,8 M	6	760 856 614	PIPE PB
3714	110X10,0	1X5,8 M	6	760 856 615	PIPE PB
3301	25-1	2	15	760 869 982	ADAPTOR
3310	25-1	2	15	760 869 983	ADAPTOR
3310	75-21/2	1	15	760 869 992	ADAPTOR
5085	20	2	19	761 065 270	BACKING FLANGES
5085	25	2	19	761 065 271	BACKING FLANGES
5085	32	2	19	761 065 272	BACKING FLANGES
5085	40	2	19	761 065 273	BACKING FLANGES
5085	50	2	19	761 065 274	BACKING FLANGES
5085	63	2	19	761 065 275	BACKING FLANGES
5085	75	2	19	761 065 276	BACKING FLANGES
5085	90	2	19	761 065 277	BACKING FLANGES
5085	110	2	19	761 065 278	BACKING FLANGES
5062	25-16	1	20	761 066 250	MANIFOLD PB SINGLE
5062	25-20	1	20	761 066 251	MANIFOLD PB SINGLE
5062	25-16	1	20	761 066 252	MANIFOLD PB DOUBLE
5062	25-16	1	20	761 066 253	MANIFOLD PB TRIPLE
5062	25-16	1	20	761 066 254	MANIFOLD PB 4 FOLD
5073	20	1	21	761 066 272	VALVE PB WITH DRAIN
5073	25	1	21	761 066 273	VALVE PB WITH DRAIN
5073	32	1	21	761 066 274	VALVE PB WITH DRAIN
5073	40	1	21	761 066 275	VALVE PB WITH DRAIN
5073	50	1	21	761 066 276	VALVE PB WITH DRAIN
5073	63	1	21	761 066 277	VALVE PB WITH DRAIN
5070	20	1	21	761 066 284	VALVE PB
5075	20	1	22	761 066 286	VALVE PB CONCEALED
5070	40	1	21	761 066 289	VALVE PB
5070	50	1	21	761 066 290	VALVE PB
5070	63	1	21	761 066 291	VALVE PB
5020	40-16-40	5	10	761 066 295	TEE 90 REDUCED
5052	75	1	15	761 066 308	ADAPTOR PIPE
5020	50-16-50	5	10	761 066 309	TEE 90 REDUCED
5020	63-16-63	5	10	761 066 310	TEE 90 REDUCED
5087	75	1	19	761 066 315	FLANGE GASKET
5087	90	1	19	761 066 316	FLANGE GASKET
5087	110	1	19	761 066 317	FLANGE GASKET
5096	25	1	23	761 066 325	VALVE BRACKET
5053	16/20-Ø15	10	12	761 066 326	ADAPTOR
5074	1/4	1	22	761 066 328	DRAIN VALVE WITH PLUG
5087	20	5	19	761 066 329	FLANGE GASKET
5087	25	5	19	761 066 330	FLANGE GASKET
5087	32	5	19	761 066 331	FLANGE GASKET
5087	40	5	19	761 066 332	FLANGE GASKET

CATALOGUE NUMBER	DIMENSION	SP	PAGE	CODE	ARTICLE
5087	50	5	19	761 066 333	FLANGE GASKET
5087	63	5	19	761 066 334	FLANGE GASKET
3420	20-32	1	24	761 066 335	SLIDE TO VALVE PB
3420	40-63	1	24	761 066 336	SLIDE TO VALVE PB
5082	20	1	25	761 066 337	BALL VALVE PVC-C
5082	25	1	25	761 066 338	BALL VALVE PVC-C
5082	32	1	25	761 066 339	BALL VALVE PVC-C
5082	40	1	25	761 066 340	BALL VALVE PVC-C
5082	50	1	25	761 066 341	BALL VALVE PVC-C
5082	63	1	25	761 066 342	BALL VALVE PVC-C
5005	16	10	8	761 066 600	ELBOW 90
5005	20	10	8	761 066 601	ELBOW 90
5005	25	10	8	761 066 602	ELBOW 90
5005	32	10	8	761 066 603	ELBOW 90
5005	40	10	8	761 066 604	ELBOW 90
5005	50	10	8	761 066 605	ELBOW 90
5005	63	2	8	761 066 606	ELBOW 90
5005	75	2	8	761 066 607	ELBOW 90
5005	90	2	8	761 066 608	ELBOW 90
5005	110	2	8	761 066 609	ELBOW 90
5010	16	10	8	761 066 610	ELBOW 45
5010	20	10	8	761 066 611	ELBOW 45
5010	25	10	8	761 066 612	ELBOW 45
5010	32	10	8	761 066 613	ELBOW 45
5010	40	5	8	761 066 614	ELBOW 45
5010	50	5	8	761 066 615	ELBOW 45
5010	63	2	8	761 066 616	ELBOW 45
5010	75	2	8	761 066 617	ELBOW 45
5010	90	2	8	761 066 618	ELBOW 45
5010	110	2	8	761 066 619	ELBOW 45
5015	16	10	9	761 066 620	TEE 90 EQUAL
5015	20	10	9	761 066 621	TEE 90 EQUAL
5015	25	10	9	761 066 622	TEE 90 EQUAL
5015	32	10	9	761 066 623	TEE 90 EQUAL
5015	40	10	9	761 066 624	TEE 90 EQUAL
5015	50	10	9	761 066 625	TEE 90 EQUAL
5015	63	5	9	761 066 626	TEE 90 EQUAL
5015	75	2	9	761 066 627	TEE 90 EQUAL
5015	90	2	9	761 066 628	TEE 90 EQUAL
5015	110	2	9	761 066 629	TEE 90 EQUAL
5030	16	10	18	761 066 630	FLANGE ADAPTOR FLAT
5030	20	10	18	761 066 631	FLANGE ADAPTOR FLAT
5030	25	10	18	761 066 632	FLANGE ADAPTOR FLAT
5030	32	10	18	761 066 633	FLANGE ADAPTOR FLAT
5030	40	10	18	761 066 634	FLANGE ADAPTOR FLAT
5030	50	10	18	761 066 635	FLANGE ADAPTOR FLAT
5030	63	2	18	761 066 636	FLANGE ADAPTOR FLAT
5030	75	2	18	761 066 637	FLANGE ADAPTOR FLAT
5030	90	2	18	761 066 638	FLANGE ADAPTOR FLAT
5030	110	2	18	761 066 639	FLANGE ADAPTOR FLAT
5031	16	10	18	761 066 640	FLANGE ADAPTOR WITH GROOVE
5031	20	10	18	761 066 641	FLANGE ADAPTOR WITH GROOVE
5031	25	10	18	761 066 642	FLANGE ADAPTOR WITH GROOVE
5031	32	10	18	761 066 643	FLANGE ADAPTOR WITH GROOVE
5031	40	10	18	761 066 644	FLANGE ADAPTOR WITH GROOVE
5031	50	10	18	761 066 645	FLANGE ADAPTOR WITH GROOVE
5031	63	2	18	761 066 646	FLANGE ADAPTOR WITH GROOVE
5031	75	2	18	761 066 647	FLANGE ADAPTOR WITH GROOVE
5031	90	2	18	761 066 648	FLANGE ADAPTOR WITH GROOVE
5031	110	2	18	761 066 649	FLANGE ADAPTOR WITH GROOVE
5050	16	10	11	761 066 650	CAP
5050	20	10	11	761 066 651	CAP
5050	25	10	11	761 066 652	CAP
5050	32	10	11	761 066 653	CAP
5050	40	10	11	761 066 654	CAP
5050	50	10	11	761 066 655	CAP
5050	63	5	11	761 066 656	CAP
5040	16	10	10	761 066 660	SOCKET
5040	20	10	10	761 066 661	SOCKET
5040	25	10	10	761 066 662	SOCKET
5040	32	10	10	761 066 663	SOCKET
5040	40	10	10	761 066 664	SOCKET
5040	50	10	10	761 066 665	SOCKET
5040	63	2	10	761 066 666	SOCKET
5040	75	2	10	761 066 667	SOCKET
5040	90	2	10	761 066 668	SOCKET
5040	110	2	10	761 066 669	SOCKET
5045	20-16	10	11	761 066 670	REDUCING BUSH
5045	25-16	10	11	761 066 671	REDUCING BUSH
5045	25-20	10	11	761 066 672	REDUCING BUSH
5045	32-20	10	11	761 066 674	REDUCING BUSH
5045	32-25	10	11	761 066 675	REDUCING BUSH
5045	40-20	10	11	761 066 677	REDUCING BUSH
5045	40-25	10	11	761 066 678	REDUCING BUSH
5045	40-32	10	11	761 066 679	REDUCING BUSH
5045	50-20	10	11	761 066 681	REDUCING BUSH
5045	50-25	10	11	761 066 682	REDUCING BUSH
5045	50-32	10	11	761 066 683	REDUCING BUSH
5045	50-40	10	11	761 066 684	REDUCING BUSH
5045	63-20	5	11	761 066 686	REDUCING BUSH
5045	63-25	5	11	761 066 687	REDUCING BUSH
5045	63-32	5	11	761 066 688	REDUCING BUSH
5045	63-40	5	11	761 066 689	REDUCING BUSH
5045	63-50	5	11	761 066 690	REDUCING BUSH
5035	16	10	16	761 066 691	UNION
5035	20	10	16	761 066 692	UNION
5035	25	10	16	761 066 693	UNION
5035	32	5	16	761 066 694	UNION
5035	40	5	16	761 066 695	UNION
5035	50	2	16	761 066 696	UNION

CATALOGUE NUMBER	DIMENSION	SP	PAGE	CODE	ARTICLE
5035	63	2	16	761 066 697	UNION
5036	16-1/2	10	16	761 066 698	ADAPTOR UNION
5036	20-1/2	10	16	761 066 699	ADAPTOR UNION
5036	25-3/4	10	16	761 066 700	ADAPTOR UNION
5036	32-1	5	16	761 066 701	ADAPTOR UNION
5036	40-11/4	5	16	761 066 702	ADAPTOR UNION
5036	50-11/2	2	16	761 066 703	ADAPTOR UNION
5036	63-2	2	16	761 066 704	ADAPTOR UNION
5037	16-1/2	10	16	761 066 705	ADAPTOR UNION
5037	20-1/2	10	16	761 066 706	ADAPTOR UNION
5037	25-3/4	10	16	761 066 707	ADAPTOR UNION
5037	32-1	5	16	761 066 708	ADAPTOR UNION
5037	40-11/4	5	16	761 066 709	ADAPTOR UNION
5037	50-11/2	2	16	761 066 710	ADAPTOR UNION
5037	63-2	2	16	761 066 711	ADAPTOR UNION
5052	32	5	15	761 066 712	ADAPTOR PIPE
5052	40	5	15	761 066 714	ADAPTOR PIPE
5052	50	3	15	761 066 716	ADAPTOR PIPE
5052	63	3	15	761 066 718	ADAPTOR PIPE
5080	20	10	18	761 066 720	O-RING
5080	25	10	18	761 066 721	O-RING
5080	32	10	18	761 066 722	O-RING
5080	40	10	18	761 066 723	O-RING
5080	50	10	18	761 066 724	O-RING
5080	63	10	18	761 066 725	O-RING
5080	16	10	18	761 066 738	O-RING
5045	75-63	2	11	761 066 742	REDUCING BUSH
5045	90-75	2	11	761 066 745	REDUCING BUSH
5045	90-63	2	11	761 066 746	REDUCING BUSH
5045	110-63	2	11	761 066 747	REDUCING BUSH
5045	110-90	2	11	761 066 748	REDUCING BUSH
5045	110-75	2	11	761 066 749	REDUCING BUSH
5100	16-63	1	26	761 066 750	HEATING ELEMENT COMPLETE (CHI)
5101	16-63	1	26	761 066 751	HEATING ELEMENT (CHI)
5110		1	27	761 066 752	METAL CASE EMPTY
5121	16-63	1	26	761 066 754	HEATING BUSHES SET
5130		1	27	761 066 756	HEATING BUSHES PAIR
5130		1	27	761 066 757	HEATING BUSHES PAIR
5130		1	27	761 066 758	HEATING BUSHES PAIR
5130		1	27	761 066 759	HEATING BUSHES PAIR
5130		1	27	761 066 760	HEATING BUSHES PAIR
5130		1	27	761 066 761	HEATING BUSHES PAIR
5130		1	27	761 066 762	HEATING BUSHES PAIR
5300	32-63	1	28	761 066 792	PIPE CUTTER
5301	32-63	1	28	761 066 793	SPARE BLADES FOR 5300
5302	25-63	1	28	761 066 794	CHAMPFERING TOOL
5303	25-110	1	28	761 066 795	SPARE BLADES FOR 5302
5310	253°C	1	29	761 066 796	TEMPIL STICK
5310	274°C	1	29	761 066 797	TEMPIL STICK
5312		1	29	761 066 798	TIMER
5320		1	29	761 066 799	GLOVES
5314	16-63	1	29	761 066 800	TEMPLATE
5102		1	27	761 066 801	SUPPORT
5100	16-63	1	26	761 066 802	HEATING ELEMENT COMPLETE 230V
5101	16-63	1	26	761 066 804	HEATING ELEMENT
5300	75-100	1	28	761 066 834	PIPE CUTTER
5301	75-100	1	28	761 066 835	SPARE BLADES FOR 5300
5302	75-100	1	28	761 066 836	CHAMPFERING TOOL
5120	16-63	1	26	761 066 841	SOCKET FUSION MACHINE
5008	16	10	8	761 066 900	ELBOW 90 SOCKET-SPIGOT
5008	20	10	8	761 066 901	ELBOW 90 SOCKET-SPIGOT
5008	25	10	8	761 066 902	ELBOW 90 SOCKET-SPIGOT
5008	32	10	8	761 066 903	ELBOW 90 SOCKET-SPIGOT
5008	40	5	8	761 066 904	ELBOW 90 SOCKET-SPIGOT
5008	50	5	8	761 066 905	ELBOW 90 SOCKET-SPIGOT
5008	63	2	8	761 066 906	ELBOW 90 SOCKET-SPIGOT
5018	16	10	9	761 066 907	ELBOW 45 SOCKET-SPIGOT
5018	20	10	9	761 066 908	ELBOW 45 SOCKET-SPIGOT
5018	25	10	9	761 066 909	ELBOW 45 SOCKET-SPIGOT
5018	32	10	9	761 066 910	ELBOW 45 SOCKET-SPIGOT
5018	40	5	9	761 066 911	ELBOW 45 SOCKET-SPIGOT
5018	50	5	9	761 066 912	ELBOW 45 SOCKET-SPIGOT
5018	63	2	9	761 066 913	ELBOW 45 SOCKET-SPIGOT
5020	20-16-20	10	10	761 066 914	TEE 90 REDUCED
5020	20-16-16	10	10	761 066 915	TEE 90 REDUCED
5020	20-20-16	10	10	761 066 916	TEE 90 REDUCED
5020	25-16-25	10	10	761 066 917	TEE 90 REDUCED
5020	25-20-25	10	10	761 066 918	TEE 90 REDUCED
5020	25-20-20	10	10	761 066 919	TEE 90 REDUCED
5020	25-25-20	10	10	761 066 920	TEE 90 REDUCED
5020	32-16-32	10	10	761 066 921	TEE 90 REDUCED
5020	32-20-32	10	10	761 066 922	TEE 90 REDUCED
5020	32-25-32	10	10	761 066 923	TEE 90 REDUCED
5020	40-25-40	5	10	761 066 924	TEE 90 REDUCED
5020	50-25-50	5	10	761 066 925	TEE 90 REDUCED
5020	63-25-63	5	10	761 066 926	TEE 90 REDUCED
5051	25	10	11	761 066 938	PLUG
5084	20	1	25	761 066 940	PB FLANGE ADAPTOR
5084	25	1	25	761 066 941	PB FLANGE ADAPTOR
5084	32	1	25	761 066 942	PB FLANGE ADAPTOR
5084	40	1	25	761 066 943	PB FLANGE ADAPTOR
5084	50	1	25	761 066 944	PB FLANGE ADAPTOR
5084	63	1	25	761 066 945	PB FLANGE ADAPTOR
5080	75	5	18	761 066 952	O-RING
5080	90	5	18	761 066 953	O-RING
5080	110	5	18	761 066 954	O-RING
5075	25	1	22	761 066 955	VALVE PB CONCEALED
5075	32	1	22	761 066 956	VALVE PB CONCEALED
5070	20	1	21	761 066 958	VALVE PB
5070	32	1	21	761 066 959	VALVE PB

CATALOGUE NUMBER	DIMENSION	SP	PAGE	CODE	ARTICLE
5081	20-11/4	10	19	761 066 971	UNION NUT
5081	25-11/2	10	19	761 066 972	UNION NUT
5081	32-2	10	19	761 066 973	UNION NUT
5081	40-21/2	10	19	761 066 974	UNION NUT
5081	50-23/4	10	19	761 066 975	UNION NUT
5081	63-31/2	2	19	761 066 976	UNION NUT
3417	25/32	1	24	761 066 979	SLEEVE VALVE PB
5081	16-1	10	19	761 066 980	UNION NUT
6215	16-1/2	1	13	761 069 360	ADAPTOR
6215	20-1/2	1	13	761 069 361	ADAPTOR
6215	20-3/4	1	13	761 069 362	ADAPTOR
6215	25-3/4	1	13	761 069 363	ADAPTOR
6215	25-1	1	13	761 069 364	ADAPTOR
6215	32-1	1	13	761 069 365	ADAPTOR
6215	40-11/4	1	13	761 069 366	ADAPTOR
6215	50-11/2	1	13	761 069 367	ADAPTOR
6215	63-2	1	13	761 069 368	ADAPTOR
6216	20-3/4	1	13	761 069 369	ADAPTOR
6216	16-3/4	1	13	761 069 370	ADAPTOR
6216	20-1	1	13	761 069 371	ADAPTOR
6216	25-3/4	1	13	761 069 372	ADAPTOR
6216	25-1	1	13	761 069 373	ADAPTOR
6216	25-11/4	1	13	761 069 374	ADAPTOR
6216	32-1	1	13	761 069 375	ADAPTOR
6216	32-11/2	1	13	761 069 376	ADAPTOR
6216	32-11/4	1	13	761 069 377	ADAPTOR
6216	40-11/4	1	13	761 069 378	ADAPTOR
6216	40-11/2	1	13	761 069 379	ADAPTOR
6217	16-1/2	1	14	761 069 380	ADAPTOR
6216	40-2	1	13	761 069 381	ADAPTOR
6217	20-3/4	1	14	761 069 382	ADAPTOR
6216	50-21/4	1	13	761 069 383	ADAPTOR
6216	50-13/4	1	13	761 069 384	ADAPTOR
6214	16-1/2	1	13	761 069 385	ADAPTOR
6214	20-1/2	1	13	761 069 386	ADAPTOR
6214	20-3/4	1	13	761 069 387	ADAPTOR
6214	25-3/4	1	13	761 069 388	ADAPTOR
6214	25-1	1	13	761 069 389	ADAPTOR
6214	32-1	1	13	761 069 390	ADAPTOR
6214	40-11/4	1	13	761 069 391	ADAPTOR
6214	50-11/2	1	13	761 069 392	ADAPTOR
6214	63-2	1	13	761 069 393	ADAPTOR
6216	63-23/8	1	13	761 069 394	ADAPTOR
6216	63-23/4	1	13	761 069 395	ADAPTOR
6230	1/2	10	17	761 069 420	SEAL
6230	3/4	10	17	761 069 421	SEAL
6230	1	10	17	761 069 422	SEAL
6230	11/4	10	17	761 069 423	SEAL
6230	11/2	10	17	761 069 424	SEAL
6230	2	10	17	761 069 425	SEAL
6230	21/4	10	17	761 069 426	SEAL
6230	23/4	10	17	761 069 427	SEAL
6218	20-15	1	14	761 069 469	ADAPTOR
6218	25-20	1	14	761 069 470	ADAPTOR
6218	32-25	1	14	761 069 471	ADAPTOR
		1	27	799 298 023	SPECIAL CLEANER TANGIT

# General Condition of Supply of Georg Fischer Piping Systems Limited, Schaffhausen

## 1 General

- 1.1 These General Conditions shall apply to all Products supplied by George Fischer to the Purchaser.  
They shall also apply to all future business even when no express reference is made to them.
- 1.2 Any deviating or supplementary conditions especially Purchaser's general conditions of purchase and verbal agreements shall only be applicable if accepted in writing by George Fischer.
- 1.3 The written form shall be deemed to be fulfilled by all forms of transmission, evidenced in the form of text, such as telex, e-mail, etc.

## 2 Tenders

Tenders shall only be binding if they contain a specifically stated period for an acceptance.

## 3 Scope of Delivery

- 3.1 George Fischer's product range is subject to change.
- 3.2 The confirmation of order shall govern the scope and execution of the contract.

## 4 Data and Documents

- 4.1 Technical documents such as drawings descriptions illustrations and data on dimensions performance and weight as well as the reference to standards are for information purposes only. They are not warranted characteristics and are subject to change.
- 4.2 All technical documents shall remain the exclusive property of George Fischer and may only be used for the agreed purposes or as George Fischer may consent.

## 5 Confidentiality, Protection of Personal Data

- 5.1 Each party shall keep in strict confidence all commercial or technical information relating to the business of the other party, of which it has gained knowledge in the course of its dealing with the other party. Such information shall neither be disclosed to third parties nor used for other purposes than those for which the information has been supplied.
- 5.2 In the context of the contractual relation with the Purchaser personal data may be processed. The Purchaser agrees to the disclosure of said data to third parties such as foreign subcontractors and suppliers etc. .

## 6 Local Laws and Regulations, Export Controls

- 6.1 The Purchaser shall bring to the attention of George Fischer all local laws and regulations at the place of destination which bear connection with the execution of the contract and the adherence to relevant safety regulations and approval procedures.
- 6.2 In case of re-exports, Purchaser shall be responsible for compliance with pertinent export control regulations.

## 7 Price

- 7.1 Unless agreed otherwise, the prices shall be deemed quoted net ex works (according to Incoterms of the ICC, latest version) including standard packing. All supplementary costs such as the cost of carriage insurance export and import licences etc. shall be borne by the Purchaser. The Purchaser shall also bear the costs of all taxes fees duties etc. connected with the contract.
- 7.2 If the costs of packing, carriage, insurance, fees and other supplementary costs are included in the tender price or contract price or are referred to specifically in the tender or confirmation of order, George Fischer reserve the right to revise their prices accordingly should any change occur in the relevant tariffs.

## 8 Terms of Payment

- 8.1 The Purchaser shall make payment in the manner agreed by the parties to the George Fischer works conducting the a count without any deductions such as discounts, costs, taxes or dues.
- 8.2 The Purchaser may only withhold or off-set payments due against counter claims which are either expressly acknowledged by George Fischer or finally awarded to the Purchaser. In particular, payment shall still be made when unessential items are still outstanding provided, however, that the Products already delivered are not rendered unusable as a result.

## 9 Retention of Title

- 9.1 The Products shall remain the property of George Fischer until the Purchaser shall have settled all claims, present and future, which George Fischer may have against him.
- 9.2 Should the Purchaser sell Products to which title is reserved, in the ordinary course of business, he shall hereby be deemed to have tacitly assigned to George Fischer the proceeds deriving from their sale together with all collateral rights, securities and reservations of title until all claims held by George Fischer shall have been settled. Until revoked by George Fischer, this assignment shall not preclude Purchaser's right to collect the assigned receivables.
- 9.3 To the extent the value of the Products to which title is reserved together with collateral securities should exceed George Fischer's claims against the Purchaser by more than 20%, George Fischer shall re-assign the above proceeds to Purchaser at his request.

## 10 Delivery

- 10.1 The term of delivery shall commence as soon as the contract has been entered into, all official formalities such as import and payment permits have been obtained and all essential technical points have been settled. The term of delivery shall be deemed duly observed when, upon its expiry, the Products are ready for despatch.
- 10.2 Delivery is subject to the following conditions, i.e. the term of delivery shall be reasonably extended:
  - a) if George Fischer are not supplied in time with the information necessary for the execution of the contract or if subsequent changes causing delays are made by the Purchaser.
  - b) if George Fischer are prevented from performing the contract by force majeure. Force majeure shall equally be deemed to be any unforeseeable event beyond George Fischer's control which renders George Fischer's performance commercially impractical or impossible, such as delayed or defective supplies from sub contractors labour disputes, governmental orders or regulations, shortages in materials or energy, serious disturbances in George Fischer's works, such as the total or partial destruction of plant and equipment or the breakdown of essential facilities, serious disruptions in transport facilities, e.g. impassable roads.  
Should the effect of force majeure exceed a period of six months, either party may cancel the contract forthwith.  
George Fischer shall not be liable for any damage or loss of any kind whatsoever resulting therefrom, any suspension or cancellation being without prejudice to George Fischer's right to re over all sums due in respect of consignments delivered and costs incurred to date.
  - c) if the Purchaser is in delay with the fulfilment of his obligations under the contract, in particular, if he does not adhere to the agreed conditions of payment or if he has failed to timely provide the agreed securities.
- 10.3 If for reasons attributable to George Fischer the agreed term of delivery or a reasonable extension thereof is exceeded, George Fischer shall not be deemed in default until the Purchaser has granted to George Fischer in writing a reasonable extension thereof of not less than one month which equally is not met.  
The Purchaser shall then be entitled to the remedies provided at law, it being however understood that, subject to limitations of Art. 16, damage claims shall be limited to max. 10% of the price of the delayed delivery.
- 10.4 Part shipments shall be allowed and George Fischer shall be entitled to invoice for such deliveries.
- 10.5 If the Purchaser fails to take delivery within a reasonable time of Products notified as ready for despatch, George Fischer shall be entitled to store the Products at the Purchaser's expense and risk and to invoice them as delivered. If Purchaser fails to effect payment, George Fischer shall be entitled to dispose of the Products.

- 10.6 Should Purchaser cancel an order without justification and should George Fischer not insist on the performance of the contract, George Fischer shall be entitled to damages in the amount of 10% of the contract price, unless George Fischer can prove higher damages.

## 11 Packing

If the Products are provided with additional packing over and above the standard packing, such packing shall be invoiced separately and be non-returnable.

## 12 Passing of Risk

- 12.1 The risk in the Products shall pass to the Purchaser as soon as they have left George Fischer's works (EX WORKS, Incoterms ICC, latest version), even if delivery is made carriage-paid, under similar clauses or including installation or when carriage is organized and managed by George Fischer.
- 12.2 If delivery is delayed for reasons beyond George Fischer's control, the risk shall pass to the Purchaser when he is notified that the Products are ready for despatch.

## 13 Carriage and Insurance

- 13.1 Unless agreed otherwise, the Purchaser shall bear the cost of carriage.
- 13.2 The Purchaser shall be responsible for transport insurance against damage of whatever kind. Even when such insurance is arranged by George Fischer it shall be deemed taken out by the order of and for the account of the Purchaser and at his risk.
- 13.3 Special requests regarding carriage and insurance shall be communicated to George Fischer in due time. Otherwise carriage shall be arranged by George Fischer at their discretion, but without responsibility, by the quickest and cheapest method possible.  
In case of carriage-paid delivery transport arrangements shall be made by George Fischer. If the Purchaser specifies particular requirements, any extra costs involved shall be borne by him.
- 13.4 In the event of damage or loss of the Products during carriage the Purchaser shall mark the delivery documents accordingly and immediately have the damage ascertained by the carrier. Not readily ascertainable damages sustained during carriage shall be notified to the carrier within six days after receipt of the Products.

## 14 Inspection and Acceptance

- 14.1 The Products will be subject to normal inspection by George Fischer during manufacture. Additional tests required by the Purchaser shall be agreed upon in writing and shall be charged to the Purchaser.
- 14.2 It shall be a condition of George Fischer's obligation under the warranties stated hereinafter that George Fischer be notified in writing by the Purchaser of any purported defect immediately upon discovery. Notice concerning weight, numbers or apparent defects is to be given latest within 30 days from receipt of the Products, notice of other defects latest within the agreed warranty period.
- 14.3 Purchaser shall not dispose of allegedly defective Products until all warranty and/or damage claims are finally settled. At its request, defective Products are to be placed at George Fischer's disposal.
- 14.4 At its request, George Fischer shall be given the opportunity to inspect the damage, prior to commencement of remedial work, either itself or by third party experts.

## 15 Warranty

- 15.1 At the written request of the Purchaser, George Fischer undertake to repair or replace at their discretion, as quickly as possible and free of charge all Products supplied which demonstrably suffer from faulty design, materials or workmanship or from faulty operating or installation instructions.  
Replaced parts shall become property of George Fischer.  
For Products which are manufactured to specifications, drawings or patterns supplied by the Purchaser, George Fischer's warranty shall be restricted to proper materials and workmanship.
- 15.2 The Purchaser shall be entitled to cancel the contract or to demand a reduction in the contract price if:
  - repair or replacement is impossible, or
  - George Fischer are unable or refuse to remedy the defect or replace the defective Products within a reasonable, or
  - George Fischer are unduly delaying such remedy or replacement.
- 15.3 For Products or essential components manufactured by a third party and supplied by George Fischer under this contract, George Fischer's warranty is limited to the warranty provided by said third party.
- 15.4 This warranty shall not apply to damage resulting from normal wear, improper storage and maintenance, failure to observe the operating instructions, oversteering or overloading, unsuitable operating media, unsuitable construction work or unsuitable building ground, improper repairs or alterations by the Purchaser or third parties, the use of non-genuine parts and other reasons beyond George Fischer's control.
- 15.5 No action or claim may be brought by the Purchaser on account of any alleged breach of warranty or any other obligation of George Fischer after the expiration of twelve (12) months from receipt of the Products by the end user or at the latest within eighteen (18) months of the Products being despatched by George Fischer.
- 15.6 In case of Products for use in domestic installations or in utilities
  - George Fischer will assume the costs of dismantling the defective Product and restoring the damaged object as well as, in case of negligence, all other direct damages caused by the defective Product (damage to property and injury to or death of persons) up to CHF 1'000'000 per occurrence.
  - the statute of limitations for warranty or damage claims - contrary to Section 15.5 - will be 5 years from the date of installation.

## 16 Limitation of Liability

All cases of breach of contract and the relevant consequences as well as all rights and claims on the part of the customer, irrespective on what ground they are based, are exhaustively covered by these general conditions of supply. In particular, any claims not expressly mentioned for damages, reduction of price, termination of or withdrawal from the contract are excluded. In no case whatsoever shall the customer be entitled to claim damages other than compensation for costs of remedying defects in the supplies. This in particular refers, but shall not be limited, to loss of production, loss of use, loss of orders, loss of profit and other direct or indirect or consequential damage. This exclusion of liability, however, does not apply to unlawful intent or gross negligence on the part of George Fischer and in case of strict liability under applicable product liability statutes, but does apply to unlawful intent or gross negligence of persons employed or appointed by the supplier to perform any of its obligations.

## 17 Severability

Should any term or clause of these General Conditions in whole or in part be found to be unenforceable or void, all other provisions shall remain in full force and effect and the unenforceable or void provision shall be replaced by a valid provision, which comes closest to the original intention of the unenforceable or invalid provision.

## 18 Place of Performance and Jurisdiction

- 18.1 Place of performance for the Products shall be the George Fischer works from which the Products are despatched.
- 18.2 Any civil action based upon any alleged breach of this contract shall be filed and prosecuted exclusively in the courts of Schaffhausen, Switzerland.  
George Fischer however reserves the right to file actions in any court having jurisdiction over controversies arising out of or in connection with the present contract.
- 18.3 The contract shall be governed by Swiss law without regard to conflict of law provisions that would require the application of another law.

1/2004

**Australia**

George Fischer Pty Ltd  
Kingsgrove NSW 2008  
Phone +61(0)2/95 54 39 77  
sales@georgfischer.com.au  
www.georgfischer.com.au

**Austria**

Georg Fischer  
Rohrleitungssysteme GmbH  
3130 Herzogenburg  
Phone +43(0)2782/856 43-0  
office@georgfischer.at  
www.georgfischer.at

**Belgium/Luxembourg**

Georg Fischer NV/SA  
1070 Bruxelles/Brüssel  
Phone +32(0)2/556 40 20  
info.be@be.piping.georgfischer.com  
www.georgfischer.be

**Brazil**

George Fischer Ltda  
04795-100 São Paulo  
Phone +55(0)11/5687 1311

**China**

Georg Fischer Piping Systems Ltd Shanghai  
Pudong, Shanghai 201319  
Phone +86(0)21/58 13 33 33  
info@cn.piping.georgfischer.com  
www.cn.piping.georgfischer.com

**Denmark/Iceland**

Georg Fischer A/S  
2630 Taastrup  
Phone +45 (0)70 22 19 75  
info@dk.piping.georgfischer.com  
www.georgfischer.dk

**France**

Georg Fischer S.A.S.  
93208 Saint-Denis Cedex 1  
Phone +33(0)1/492 21 34 1  
info@georgfischer.fr  
www.georgfischer.fr

**Germany**

Georg Fischer GmbH  
73095 Albershausen  
Phone +49(0)7161/302-0  
info@georgfischer.de  
www.vgd.georgfischer.de

Georg Fischer DEKA GmbH  
35232 Dautphetal-Mornshausen  
Phone +49(0)6468/915-0  
info@dekapipe.de  
www.dekapipe.de

**Greece**

Georg Fischer S.p.A.  
10434 Athens  
Phone +30(0)1/882 04 91  
office@piping-georgfischer.gr

**India**

Georg Fischer Piping Systems Ltd  
400 093 Mumbai  
Phone +91(0)22/2820 2362  
branchoffice@georgfischer.net

**Italy**

Georg Fischer S.p.A.  
20063 Cernusco S/N (MI)  
Phone +3902/921 861  
office@piping.georgfischer.it  
www.georgfischer.it

**Japan**

Georg Fischer Ltd  
556-0011 Osaka,  
Phone +81(0)6/6635 2691  
info@georgfischer.jp  
www.georgfischer.jp

**Malaysia**

Georg Fischer (M) Sdn. Bhd.  
47500 Subang Jaya  
Phone +60 (0)3-8024 7879  
conne.kong@georgfischer.com.my

**Netherlands**

Georg Fischer N.V.  
8161 PA Epe  
Phone +31(0)578/678 222  
info.vgnl@nl.piping.georgfischer.com  
www.georgfischer.nl

**Norway**

Georg Fischer AS  
1351 Rud  
Phone +47(0)67 18 29 00  
info@no.piping.georgfischer.com  
www.georgfischer.no

**Poland**

Georg Fischer Sp. z o.o.  
02-226 Warszawa  
Phone +48(0)22/313 10 50  
www.georgfischer.pl

**Romania**

Georg Fischer  
Rohrleitungssysteme AG  
70000 Bucharest - Sector 1  
Phone +40(0)1/222 91 36  
office@georgfischer.ro

**Singapore**

Georg Fischer Pte Ltd  
417 845 Singapore  
Phone +65(0)67 47 06 11  
info@georgfischer.com.sg  
www.georgfischer.com.sg

**Spain/Portugal**

Georg Fischer S.A.  
28046 Madrid  
Phone +34(0)91/781 98 90  
info@georgfischer.es  
www.georgfischer.es

**Sweden/Finland**

Georg Fischer AB  
12523 Älvsjö-Stockholm  
Phone +46(0)8/506 775 00  
info@georgfischer.se  
www.georgfischer.se

**Switzerland**

Georg Fischer Rohrleitungssysteme (Schweiz) AG  
8201 Schaffhausen  
Phone +41(0)52 631 30 26  
info@rohrleitungssysteme.georgfischer.ch  
www.piping.georgfischer.ch

**United Kingdom/Ireland**

George Fischer Sales Limited  
Coventry, CV2 2ST  
Phone +44(0)2476 535 535  
info@georgfischer.co.uk  
www.georgfischer.co.uk

**USA/Canada/Latin America/Caribbean**

George Fischer Inc.  
Tustin, CA 92780-7258  
Phone +1(714) 731 88 00, Toll Free 800/854 40 90  
info@us.piping.georgfischer.com  
www.us.piping.georgfischer.com

**Export**

Georg Fischer Rohrleitungssysteme (Schweiz) AG  
8201 Schaffhausen  
Phone +41(0)52 631 11 11  
export@piping.georgfischer.com  
www.piping.georgfischer.com