

FUSEAL Sea Drain

FUSEAL Sea Drain has excellent chemical and physical properties to make the system ideal for handling corrosive chemical waste solutions present in laboratory and industrial DWV applications. Fuseal is suitable for use in the ship building industries as well as in areas where mixtures of acids, bases, and solvents are drained.

The FUSEAL Sea Drain piping system's polypropylene PPFR compound (FR=flame retardant) yields a combination of high chemical resistance, toughness and high strength at elevated temperatures which is ideal for a wide range of conditions including corrosive chemical waste solutions. FUSEAL Sea Drain is also suitable for use in black and grey water sanitary drains as cabins , galleys and laundries etc., scuppers and discharges (overboard), sounding air and venting of water tanks / dry spaces, vent pipes etc.

The MSA 250SE power unit features barcode operation, multiple joint and advanced transformer technology.

The Fuseal II fusion collar (1 1/2" to 6") provides simple insertion of pipe without coil removal.

Advantages of FUSEAL Sea Drain

- High thermal ageing and thermal forming resistance
- Low creep elongation
- Handles corrosive drainage fluids up to 180°F (80°C) for short intervals up to 210°F (approx. 100°C)
- Non-essential and non-pressure drainage system rated to 1.76 bars (25 %)
- full vacuum
- No corrosion
- Conforms to the ASTM F-1412 standard specifications for polyolefine pipe and fittings for corrosive waste drainage system
- The piping system is not tested with respect to Fire Endurance
- Tested to Low Flame Spread acc. ASTM D635.
- High stress fracture resistance
- Easy installation (electrofusion)
- Long service life
- Pipe and fitting size dimensions range from 1 1/2" to 6" (bigger on request)

Application for Ship Building

- Grey and black water
- scuppers and discharges (overboard), sounding air and venting of water tanks / dry spaces, vent pipes etc.

Dimension range

- 1 1/2" to 6" (bigger size on request)

Temperature range

0°C to +80°C (short term 100°C)

FUSEAL Sea Drain

	Page
Pipes	296
Fittings	296
Transition Fittings	300
Clean outs	303
Accessories/Tools	304

Fuseal

Corrosive Waste Pipe – Schedule 40

Material: Flame Retardant Polypropylene

8" thru 16" Pipe F.O.B. Plant – Freight Paid by Customer

PPFR Schedule 40 Group I Pipe – 10 ft. lengths (except 8")

P/L 23

Inch Size	Part Number	Lift Qty (ft.)	avg. od	min. wall
1½	F8004-015AA	1800	1.900	0.145
2	F8004-020AA	1050	2.375	0.154
3	F8004-030AA	580	3.500	0.216
4	F8004-040AA	510	4.500	0.237
6	F8004-060AA	220	6.625	0.280

*20' length

20' lengths available upon request

PPFR Fusion Fittings – Schedule 40

P/L 51 Fabricated (part number ends with "F")

P/L 52 Molded

Material: Flame Retardant Polypropylene

6" through 12" fittings require the use of a metal band clamp; metal band clamps must be ordered separately.

Note: Custom fittings available on request.

Coupling (S x S)

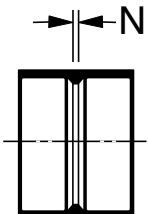

Inch Size	Part Number	Std. Pack	N
1½	527001	50	0.06
2	527002	45	0.06
3	527003	60	0.13
4	527004	20	0.13
6	527006	10	0.19

Sleeve Coupling (S x S)

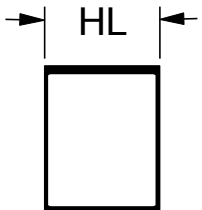

Inch Size	Part Number	Std. Pack	HL
1½	527041	2	1.56
2	527042	2	1.81
3	527043	2	2.00
4	527044	2	2.00
6	527046	2	2.69

1/4 Bend – Long Sweep (S x S)

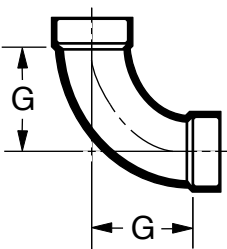

Inch Size	Part Number	Std. Pack	G
1½	526276	30	2.75
2	526277	30	3.25
3	526278	15	4.06
4	526279	4	4.94
6	526280F	2	11.00

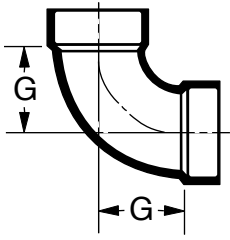

1/4 Bend – Short Sweep (S x S)

Inch Size	Part Number	Std. Pack	G
1½	526251	45	1.75
2	526252	25	2.31
3	526253	30	3.06
4	526254	10	3.88
6	526256	5	5.63

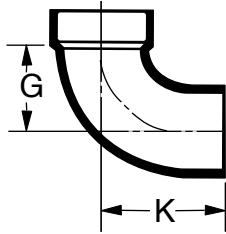

1/4 Bend – Street (Spg x S)

Inch Size	Part Number	Std. Pack	G	K
1½	526451	35	1.75	3.11
2	526452	30	2.31	3.80
3	526453	5	3.06	4.75
4	526454	5	3.88	5.38
6	526456F	2	11.00	10.81

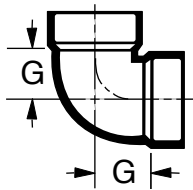

1/4 Bend – Vent (S x S)

Inch Size	Part Number	Std. Pack	G
1½	526201	40	1.19
2	526202	30	1.50
3	526203	5	1.88

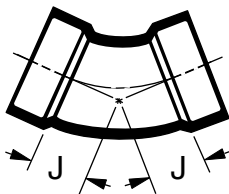

1/6 Bend (S x S)

Inch Size	Part Number	Std. Pack	J
1½	526601	10	1.00
2	526602	10	1.31
3	526603	5	1.69
4	526604	2	2.06

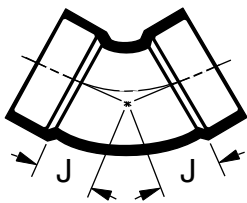

1/8 Bend (S x S)

Inch Size	Part Number	Std. Pack	J
1½	526501	40	1.13
2	526502	25	1.50
3	526503	20	1.75
4	526504	10	2.19
6	526506	5	3.37

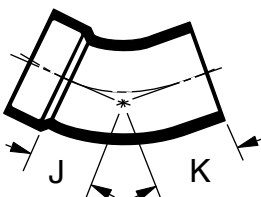

1/8 Bend – Street (Spg x S)

Inch Size	Part Number	Std. Pack	J	K
1½	526401	45	1.13	2.44
2	526402	30	1.50	2.50
3	526403	15	1.75	3.25
4	526404	10	2.19	3.25
6	526406	5	3.38	4.75

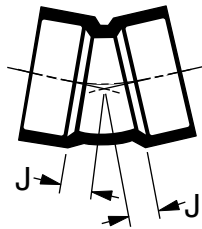

1/16 Bend (S x S)

Inch Size	Part Number	Std. Pack	J
2	526552	15	0.69
3	526553	2	0.81
4	526554	5	1.00

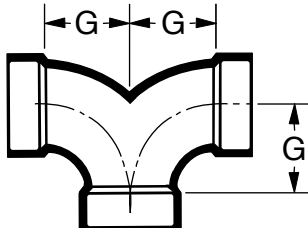

3-Way Ell (S x S x S)

Inch Size	Part Number	Std. Pack	G
1½	526261	5	1.75
2	526262	10	2.31

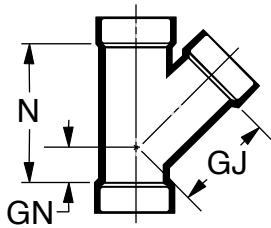

45° Wye (S x S x S)

Inch Size	Part Number	Std. Pack	GJ	GN	N
1½	526301	20	2.88	1.13	4.00
2	526302	10	3.63	1.38	5.00
3	526303	10	5.00	1.63	6.63
4	526304	5	6.38	1.88	8.25
6	526306	2	9.13	1.63	10.75

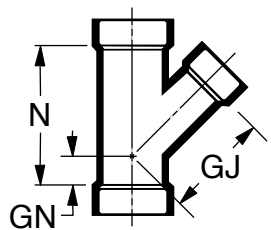

45° Wye - Reducing (S x S x S)

Inch Size	Part Number	Std. Pack	GJ	GN	N
2x2x1½	526325	20	3.44	1.06	4.38
3x3x1½	526324	15	4.63	0.88	5.00
3x3x2	526326	15	4.63	0.88	5.00
4x4x2	526328	10	5.56	0.38	5.06
4x4x3	526327	10	6.00	1.06	6.63
6x6x2	526342	2	6.75	0.13	4.73
6x6x3	526343	3	7.43	0.19	6.38
6x6x4	526344	4	7.75	0.68	7.73

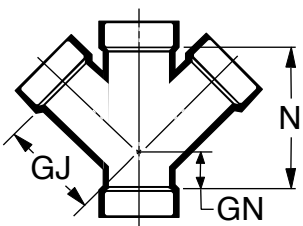

45° Wye - Double (S x S x S)

Inch Size	Part Number	Std. Pack	GJ	GN	N
1½	526380	4	3.50	1.13	4.63
2	526381	4	4.00	1.38	5.38
3	526382	1	5.00	1.63	7.63
4	526383	1	6.38	1.88	9.25
6	526351F	1	12.25	6.18	18.88

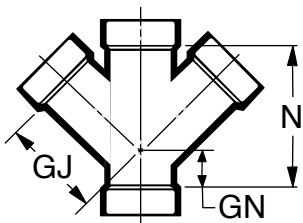

45° Wye - Double Reducing (S x S x S x S)

Inch Size	Part Number	Std. Pack	GJ	GN	N
2x2x1½x1½	526384	2	3.44	1.06	5.38
3x3x1½x1½	526389	1	4.31	.50	5.25
3x3x2x2	526385	1	4.63	.88	6.00
4x4x2x2	526386	1	5.56	.38	6.06
4x4x3x3	526387	1	6.00	1.06	7.63
6x6x3x3	526390F	1	9.25	0.68	7.75
6x6x4x4	526388	1	7.75	0.69	7.75

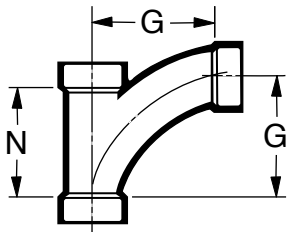

Long Turn Tee Wye (S x S x S)

Inch Size	Part Number	Std. Pack	G	N
1½	527301	20	3.94	3.63
2	527302	25	5.13	4.44
3	527303	10	7.56	6.50
4	527304	5	9.82	8.75

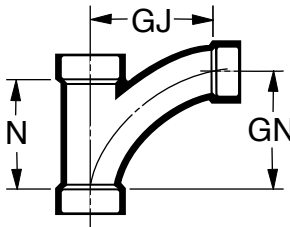

Long Turn Tee Wye - Reducing (S x S x S)

Inch Size	Part Number	Std. Pack	GJ	GN	N
2x2x1½	527320	20	4.19	3.94	3.63
3x3x1½	527326	5	4.75	3.94	3.81
3x3x2	527327	12	5.69	5.13	4.75
4x4x2	527337	5	6.13	5.13	4.50
4x4x3	527338	8	8.06	7.56	6.50

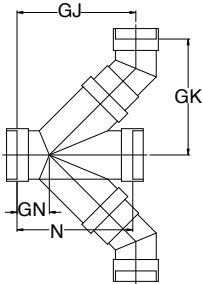

Combo Wye and 1/8 Bend - Double (S x S x S x S)

Inch Size	Part Number	Std. Pack	GJ	GK	GN	N
1½	526801	1	5.31	5.31	1.13	4.63
2	526802	1	5.98	6.10	1.38	5.38
3	526803	1	7.47	7.59	1.63	7.63
4	526804	1	8.69	9.00	1.88	9.25
6	526806F	1	18.18	15.38	6.18	18.38
8	526808F	1	22.50	22.50	7.00	22.50

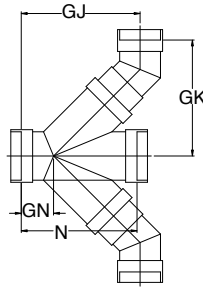

Combo Wye and 1/8 Bend - Double Reducing (S x S x S x S)

Inch Size	Part Number	Std. Pack	GJ	GK	GN	N
2x2x1½x1½	526825	1	5.22	5.27	1.06	5.38
3x3x1½x1½	526824	1	5.27	5.89	0.50	5.25
3x3x2x2	526826	1	5.91	6.54	0.88	6.00
4x4x2x2	526828	1	6.08	7.20	0.38	6.06
4x4x3x3	526827	1	7.61	8.29	1.06	7.63
6x6x3x3	526843F	1	9.52	10.59	0.69	7.13
6x6x4x4	526844F	1	8.46	9.97	0.69	7.13
8x8x4x4	526846F	1	21.00	15.38	7.00	22.50
8x8x6x6	526845F	1	22.25	18.75	7.00	22.50

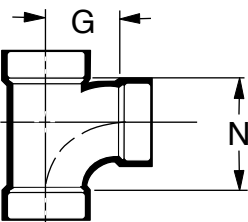

Sanitary Tee (S x S x S)

Inch Size	Part Number	Std. Pack	G	N
1½	526151	50	1.75	2.75
2	526152	10	2.31	3.69
3	526153	15	3.06	4.88
4	526154	12	3.88	6.13
6	526156F	1	14.25	20.38

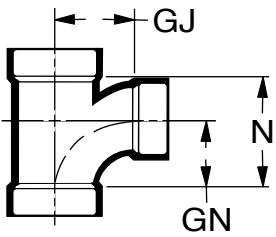

Sanitary Tee - Reducing (S x S x S)

Inch Size	Part Number	Std. Pack	GJ	GN	N
2x2x1½	526126	30	2.21	1.96	3.17
3x3x1½	526131	15	2.56	1.75	2.68
3x3x2	526130	20	2.88	2.13	3.31
4x4x2	526134	10	3.31	2.06	3.19
4x4x3	526136	5	3.56	3.00	4.75
6x6x3	526138F	2	6.40	3.93	6.13
6x6x4	526139	2	4.90	3.93	6.13

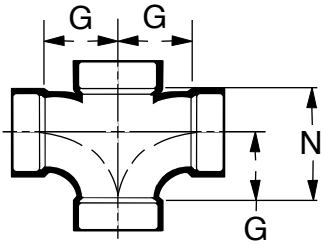

Sanitary Tee - Double (S x S x S x S)

Inch Size	Part Number	Std. Pack	G	N
1½	526187	5	1.75	2.75
2	526186	5	2.31	3.69
4	526185	4	4.50	6.13

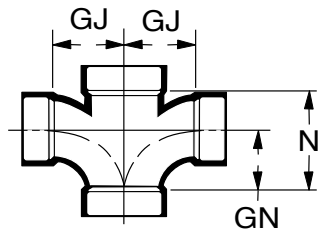

Sanitary Tee - Double Reducing (S x S x S x S)

Inch Size	Part Number	Std. Pack	GJ	GN	N
2x2x1½x1½	526188	2	2.19	1.94	3.13
3x3x1½x1½	526184F	2	4.48	2.13	3.31
3x3x2x2	526181	2	2.88	2.13	3.31

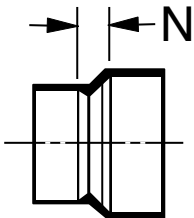

Pipe Increaser (S x S)

Inch Size	Part Number	Std. Pack	N
1½x2	527022	40	0.53
1½x3	527023F	15	0.88
2x3	527024	15	0.88
2x4	527025	5	1.38
3x4	527026	5	0.94
3x6	527027F	1	1.03
4x6	527028F	1	1.03

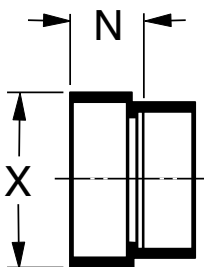

Reducer Bushing (Spg x S)

Inch Size	Part Number	Std. Pack	N	X
2x1½	526752	30	1.61	2.38
3x1½	526762	15	1.50	3.50
3x2	526754	40	1.50	3.50
4x2	526758	15	1.13	4.50
4x3	526756	20	1.50	4.50

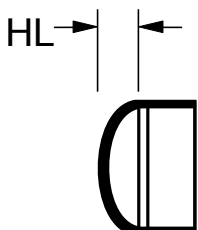

Cap (S)

Inch Size	Part Number	Std. Pack	HL
1½	527081	35	0.53
2	527082	50	0.32
3	527083	20	0.91
4	527084	5	1.09
6	527087	2	1.56

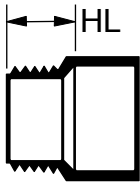

Male Adapter (S x MPT)

Inch Size	Part Number	Std. Pack	HL
1½	526871	50	1.18
2	526872	40	1.25
3	526873	15	1.84
4	526874	10	2.00
6	526876F	1	3.50

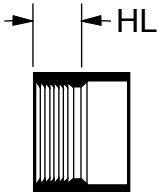

Female Adapter (S x FPT)

Inch Size	Part Number	Std. Pack	HL
1½	526891	50	1.12
2	526892	50	1.15
3	526893	18	1.72
4	526894	10	1.81
6	526896	2	2.82

Fuseal Transition Couplings



Part Number	Inch - metric
8880	1-1/2" to 53-55 mm Transition Coupling (PP to Metal)
8881	2" to 53-55 mm Transition Coupling (PP to Metal)
8882	2" to 75-77 mm Transition Coupling (PP to Metal)
8883	3" to 88-90 mm Transition Coupling (PP to Metal)
8884	4" to 102-110 mm Transition Coupling (PP to Metal)
8886	6" to 159-160 mm Transition Coupling (PP to Metal)

Flange - DIN

Part Number	
526921M	1-1/2" Flange Hub (S) (Must Order Backing Flange PP/V)
526922M	2" Flange Hub (S) (Must Order Backing Flange PP/V)
526923M	3" Flange Hub (S) (Must Order Backing Flange PP/V)
526924M	4" Flange Hub (S) (Must Order Backing Flange PP/V)
526926M	6" Flange Hub (S) (Must Order Backing Flange PP/V)

Flange - DIN

Part Number	
727700410	DIN Backing Flanges PP/V 50DN40
727700411	DIN Backing Flanges PP/V 63DN50
727700413	DIN Backing Flanges PP/V 90DN80
727700414	DIN Backing Flanges PP/V 110DN100
727700417	DIN Backing Flanges PP/V D160DN150 (6")
748440305	Flange gasket EPDM 42x92x3/4 50
748440306	Flange gasket EPDM 53x107x4/5 63
748440308	Flange gasket EPDM 76x142x4/5 90
748440309	Flange gasket EPDM 93x162x5/6 110
748440312	Flange gasket EPDM 135x218x6/8 160

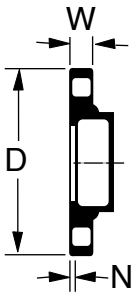

Flange – ANSI 150lb. Pattern (S)

Inch Size	Part Number	Std. Pack	# holes	bolt hole dia.	bolt cir. dia.	D	N	W
1½	526921	10	4	0.56	3.88	5.00	0.16	0.66
2	526922	10	4	0.68	4.75	6.00	0.19	0.75
3	526923	8	4	0.75	6.00	7.50	0.22	0.94
4	526924	10	8	0.75	7.50	9.00	0.21	1.14
6*	526926	3	8	0.88	9.50	10.94	0.28	1.00

*Van Stone Style

Vertical/Horizontal Expansion Joint (Spg x S)

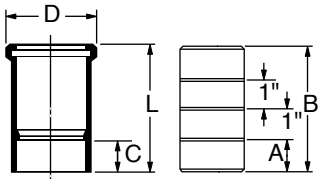

Inch Size	Part Number	Std. Pack	A	B	C	D	L
1½	527811A	1	0.97	4.09	0.75	2.65	4.10
2	527812A	1	1.19	4.53	0.88	3.15	4.50
3	527813A	1	1.59	5.31	0.94	4.64	5.25
4	527814A	1	2.09	6.34	0.94	5.78	5.69

O-Ring material: EPDM

Fuseal Cleanouts and Floor Drains

P/L 51 Fabricated (part number ends with "F")

P/L 52 Molded

Material: Flame Retardant Polypropylene

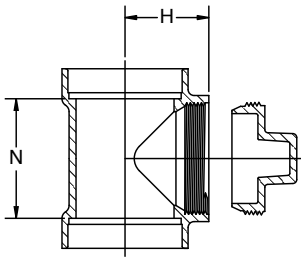

Cleanout Tee with Plug (S x S x FT)

Inch Size	Part Number	Std. Pack	H	N
1½	526114A	5	1.82	2.12
2	526115A	15	2.13	2.74
3	526116A	5	2.63	3.75
4	526117A	10	3.38	5.00
6	526118AF	1	7.00	18.00

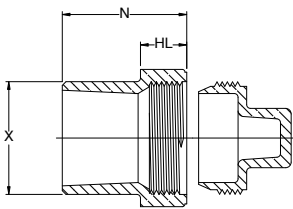

Cleanout Adapter with Plug (Spg x FT)

Inch Size	Part Number	Std. Pack	HL	N	X
1½	7701A	40	0.78	2.09	1.90
2	7702A	50	0.78	2.22	2.38
3	7703A	18	1.09	2.66	3.50
4	7704A	8	1.13	2.94	4.50
6	7706A	5	1.31	2.63	6.63

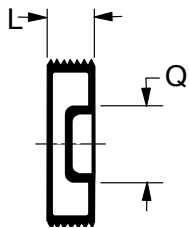

Countersunk Plug for Cleanout (MT)

Inch Size	Part Number	Std. Pack	L	Q
3	7063	10	1.03	1.31
4	7064	5	1.16	1.63

Plug (MT)

(Used with cleanout tees, cleanout adapters, and cleanout p-traps only)

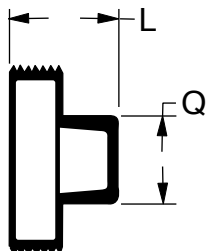

Inch Size	Part Number	Std. Pack	L	Q
1	7049	1	0.99	0.75
Used for 527201A & 527202A only				
1½	7051	120	1.56	1.00
Also used for 527203A & 527204A				
2	7052	15	1.54	1.25
3	7053	5	2.03	1.63
4	7054	5	2.16	2.00
6	7057	10	2.38	2.38

Fuseal Traps

P/L 51 Fabricated (part number ends with "F")

P/L 52 Molded

Material: Flame Retardant Polypropylene

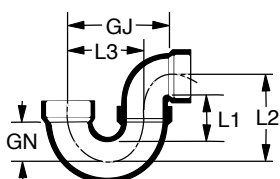

P Trap (S x S)

Inch Size	Part Number	Std. Pack	GJ	GN	L1	L2	L3
1½	527201	40	4.71	1.68	2.06	3.64	3.50
2	527202	20	6.94	2.44	2.71	4.75	5.06
3	527203	10	8.88	2.79	3.41	6.43	6.75
4	527204	6	10.75	3.88	3.88	8.06	8.50

Fuseal Fusion Accessories

P/L 07 Fusion Accessories

Standard Pack Quantities; No broken Packs



MSA Fusion Unit

(includes (5) Cable Assembly, Bar Code Set with Tester and Metal Case)

	Part Number	Std. Pack
110v	MSA250-SE	1
220v	799 350 404 MSA250-EX Multi for Fuseal / ELGEF INSTAFLEX 125-225	1

MSA Accessories

	Part Number	Std. Pack
Bar Code Set	MSABAR	1
Continuity Tester	TA1000	1

MSA Fusion Cable

	Part Number	Std. Pack
Single Cable	MSA001	1
(5) Cable Assembly	MSA001A	1

MSA Carrying Case

	Part Number	Std. Pack
Metal Case	MSA2000	1

Fusion Collar with Plastic Clamp

6" fusion collars without plastic clamp



Inch Size	Part Number	Std. Pack
1½	6282	10
2	6283	10
3	6284	10
4	6285	10
6	6287	10

Plastic Clamp



Inch Size	Part Number	Std. Pack
1½	FU1282	10
2	FU1283	10
3	FU1284	10
4	FU1285	10

Metal Clamp

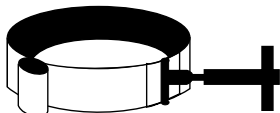

Inch Size	Part Number	Std. Pack
4	FU110	4
6	FU112	1